

2 door wings
 $w = (W : 2) + 10 \text{ mm}$
 $x = x + t + 8 \text{ mm}$

X, X₁ - depth of wardrobe side
 W - wardrobe width
 w - door width
 t - door thickness
 t_s - side thickness

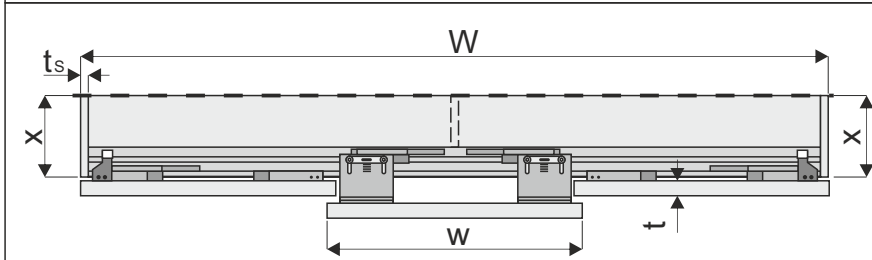

3 door wings
 $w = (W : 3) + 10 \text{ mm}$

X - depth of wardrobe side
 W - wardrobe width
 w - door width
 t - door thickness
 t_s - side thickness

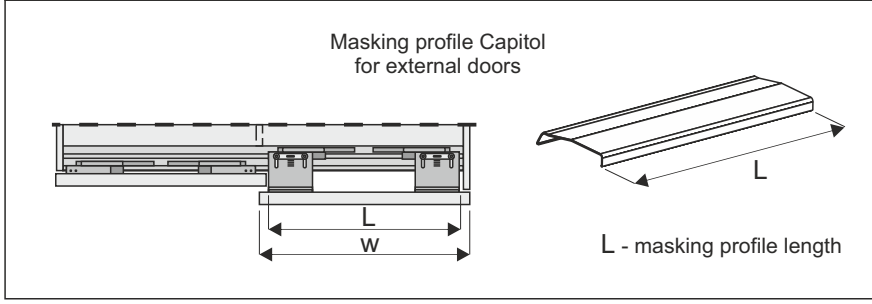

Set for Capitol - 1 central door

- Roller x2
- Bracket x2
- Screw x 20
- Bracket x4
- Screw x2

COMPONENTS

Bottom track Capitol

Top track Capitol

Set for sliding door Capitol - 2 door wings

- Roller x4
- Bracket x2
- Bracket x2
- Screw x4
- Screw x4
- Screw x4
- Plate
- Screw x40

Masking profile Capitol



Carriage fastening

①
drill openings
using template

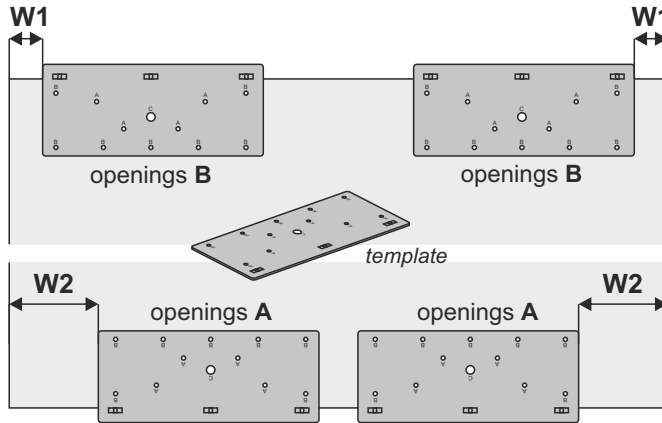

$W1 = \text{min. } 25 \text{ mm} + t_s$
 $W2 = \text{min. } 100 \text{ mm} + t_s$
(with lower bumper stoppers)
 $W2 = \text{min. } t_s$
(without lower bumper stoppers)

②
fasten top carriages
and soft close
mechanisms

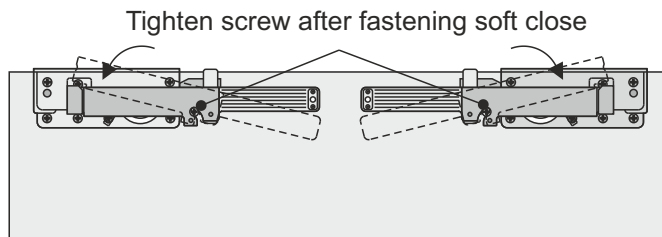

Tighten screw after fastening soft close

③
fasten bottom
carriages



ATTENTION
We recommend using Sevroll's door
straightening kit with this system.

Track installation

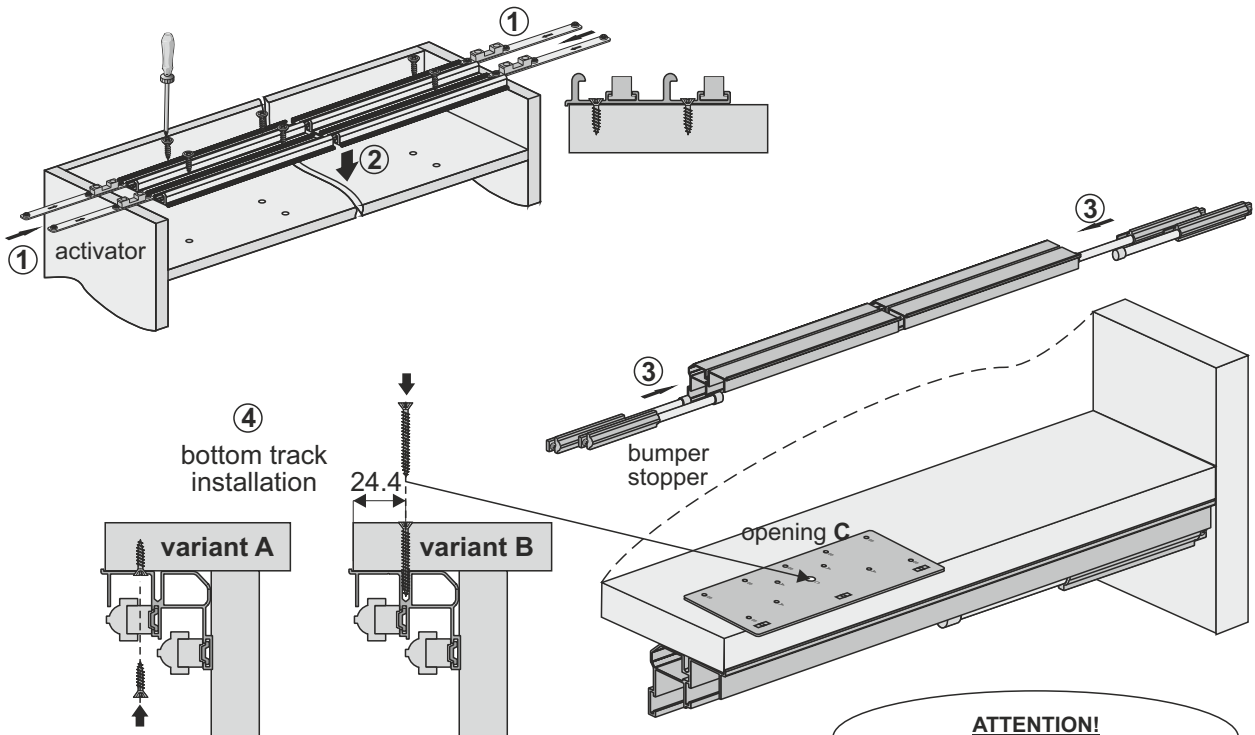

ATTENTION!
Set does not includes track screws



Door installation

Depending on door thickness used, **prior to assembly**, the external guides need to be adjusted correctly

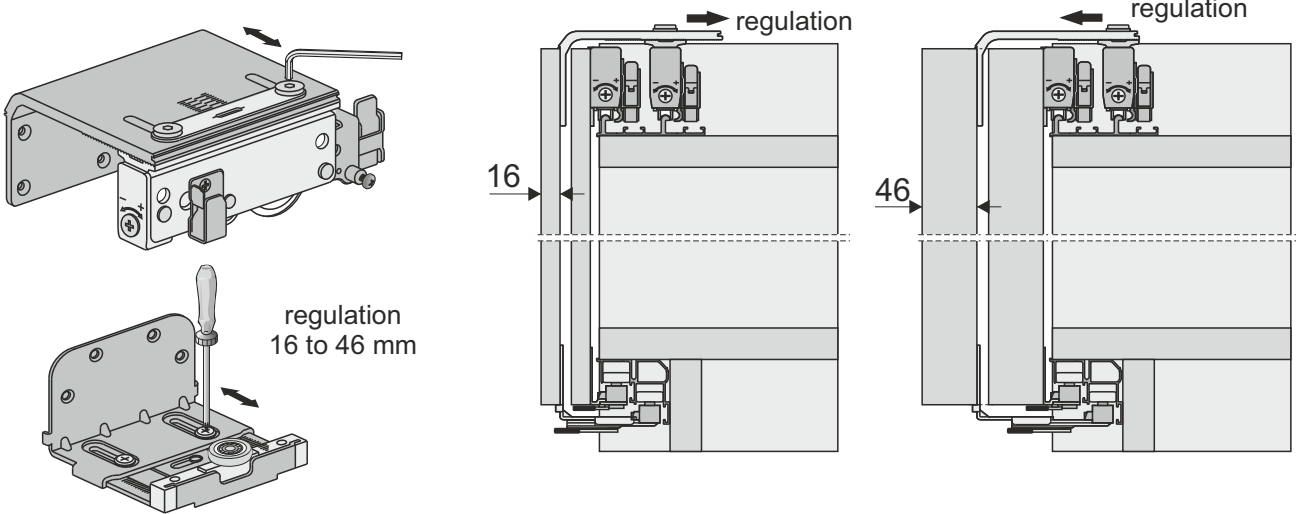

door assembly order

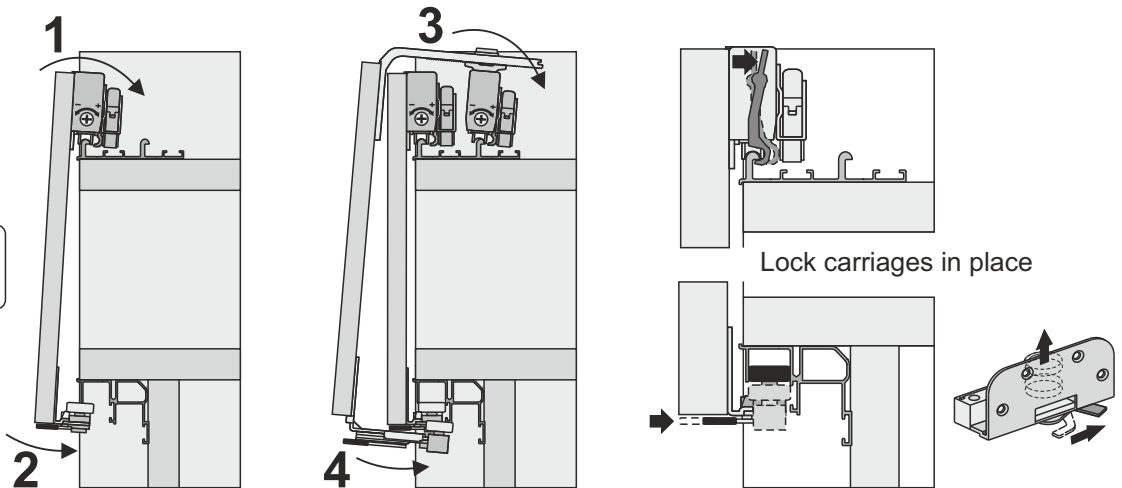

Adjustment

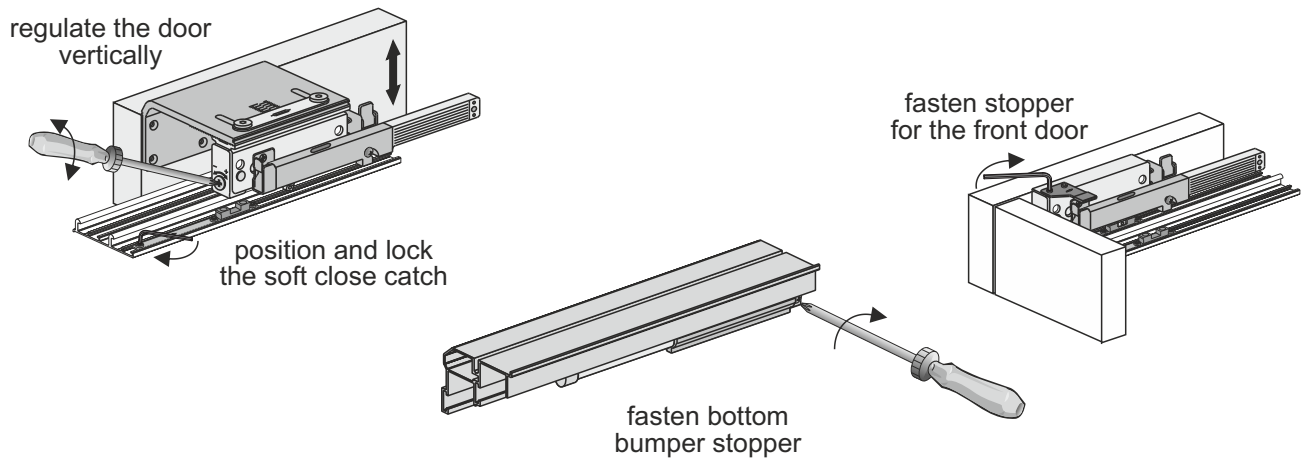



Set for three wings – assembly of central soft-close

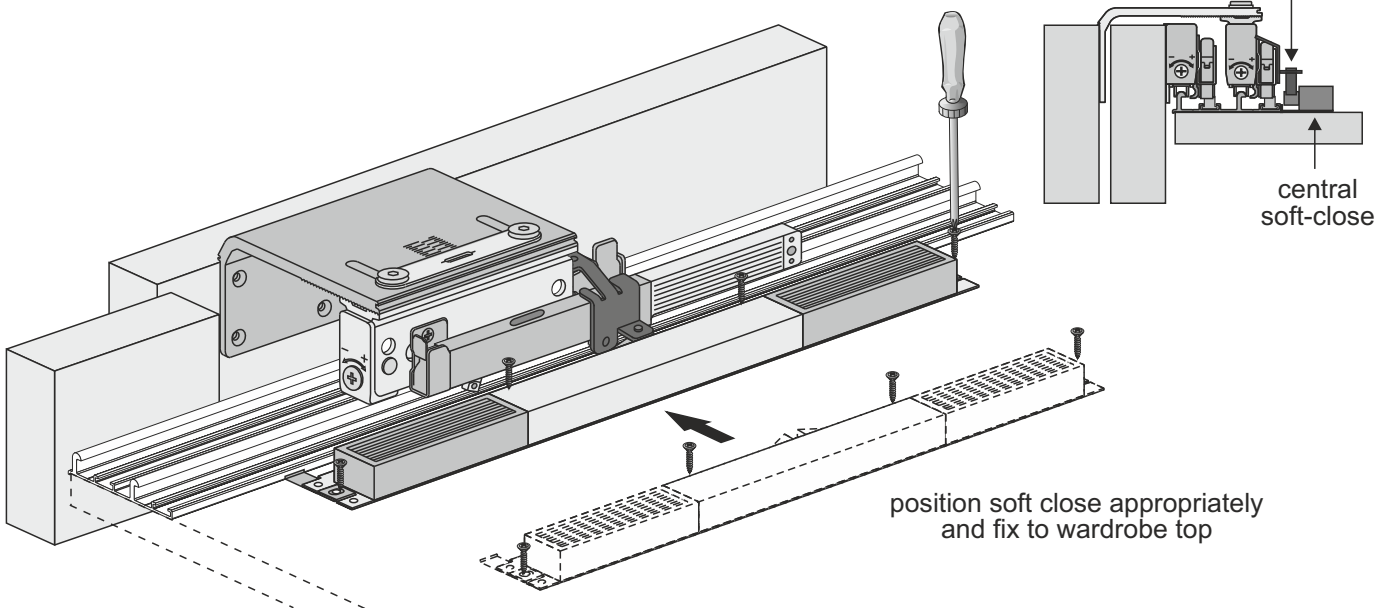
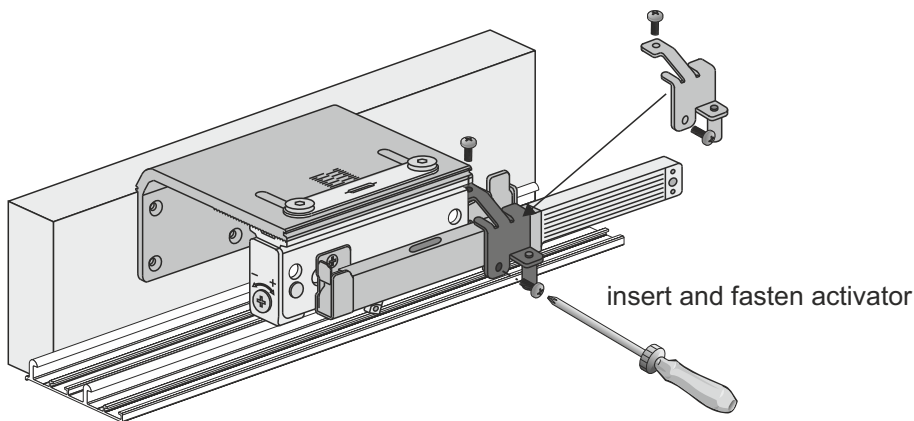
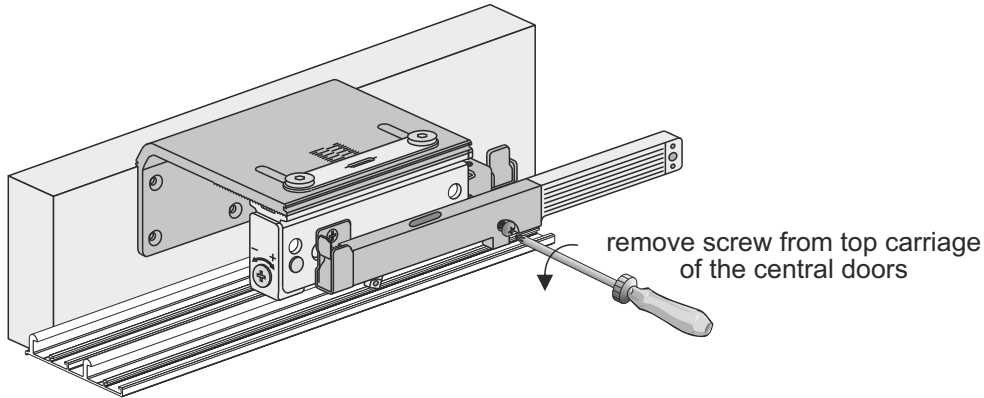
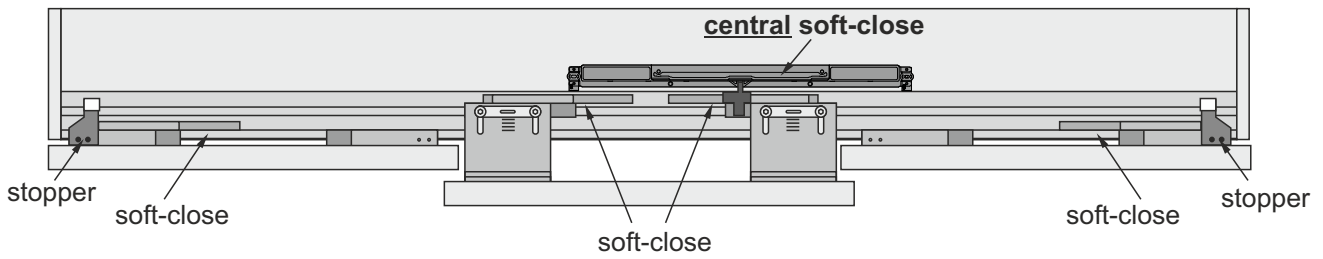

ATTENTION! Remove protective film from aluminium elements (handles, tracks, connectors, etc.) prior to cutting them to the desired size. Film removal will reveal quality issues (eg. scratches)