

ATTENTION
When installing the fixed mounting, it is important to situate axis L parallel to axis K (L || K)

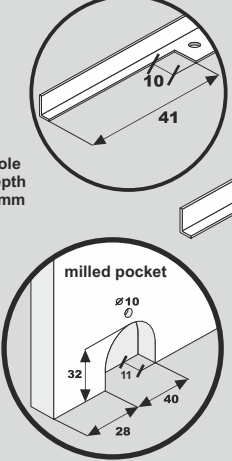
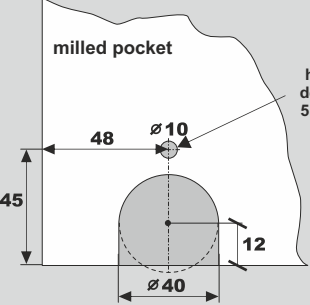

ATTENTION:
For fast and accurate routing of the bottom carriage pockets we recommend using stencil for bottom carriage WD18 HI-TEC index 20191

Installation of bottom track Gemini-Decor II using our mounting bush

Fastening of bottom track (countersink holes to prevent protrusion of screw head)

Option: bottom track ELEGANT II

With BETA, FOCUS set you may use bottom track **Elegant II with covering strip** along with bottom carriage WD 18V HI-TEC. **Fitting measurements are not affected.**

COMPONENTS

Handle
L: 2.70 m

BETA C #16, #18 **FOCUS #16, #18**

Top track Gemini-Decor
L: 1.70 m, 2.35 m, 3.00 m, 4.05 m, 6.00 m

76 mm

Bottom track Gemini-Decor II
L: 1.70 m, 2.35 m, 3.00 m, 4.05 m, 6.00 m

53 mm

Guiding carriage Focus

Angle section Mini 11 mm x 17 mm
L: 1.70 m, 2.35 m, 3.00 m

Bottom carriage WD18C HI-TEC

Bottom carriage WD18V HI-TEC

Stopper HI-TEC

Fastening of bottom track (special screw)



Dimensions of opening

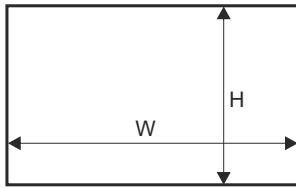

Handle length = door height

		BETA C				FOCUS			
		anti-dust brushes (self-adhesive) 6.7 mm x 13 mm textile door stop (self-adhesive) 4.8 mm x 4 mm #16, #18				anti-dust brushes (self-adhesive) 6.7 mm x 13 mm textile door stop (self-adhesive) 4.8 mm x 4 mm #16, #18			
door height	- h	h = H - 42 mm				h = H - 42 mm			
door wing height with soft-close fitted		Mini SV25/40/60 SV-25/50	h = H - 42 mm			Mini SV25/40/60 SV-25/50	h = H - 42 mm		
		Top SV60/80, Central SV25/40	h = H - 44 mm			Top SV60/80, Central SV25/40	h = H - 44 mm		
board height	- hb	hb = h - 2 mm				hb = h - 2 mm			
door width	- w	w = (W - 3 mm + Z) : N				w = (W - 3 mm + Z) : N			
board width	- wb	wb = w - 3 mm				wb = w - 3 mm			
angle section length	- la	la = w - 32,5 mm				la = w - 58 mm			

number of doors	- N	2	3	4	5	2	3	4	5
total overlap	- Z	29 mm	58 mm	87 mm	116 mm	30 mm	60 mm	90 mm	120 mm

visual design – 4 wings									
	door set up	w = (W - 3 + 87) : 4				w = (W - 3 + 90) : 4			
	door set up	w = (W : 2 + 26) : 2				w = (W : 2 + 27) : 2			

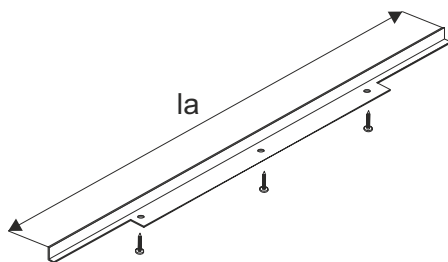
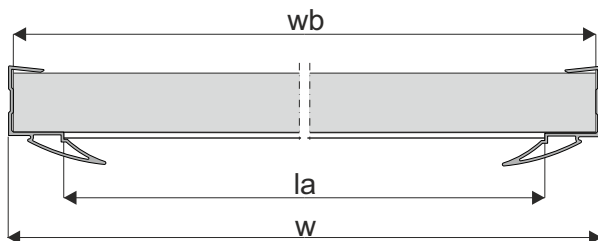

ATTENTION!

Handle profile should be 2 mm longer than board height.

WARNING

SEVROLL does not bear any responsibility for deformation resulting from the application of improper quality of boards (improper storage, improper humidity)

BETA C

Installation method for handle and guiding carriage with # 16 mm or # 18 mm board

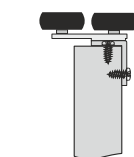
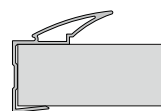

Installation method for angle section MINI 11 x 17 mm



FOCUS

Installation method for handle and guiding carriage with # 16 mm or # 18 mm board

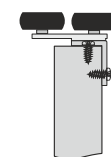

Installation method for angle section MINI 11 x 17 mm



- When fitting handle profiles, do not use assembly adhesive

ATTENTION!

Remove protective film from aluminium elements (handles, tracks, connectors, etc.) prior to cutting them to the desired size. Film removal will reveal quality issues (eg. scratches)