



LINE

Pax XL

SYSTEM

EDEN 4 – 3 door wings

SEVROLL

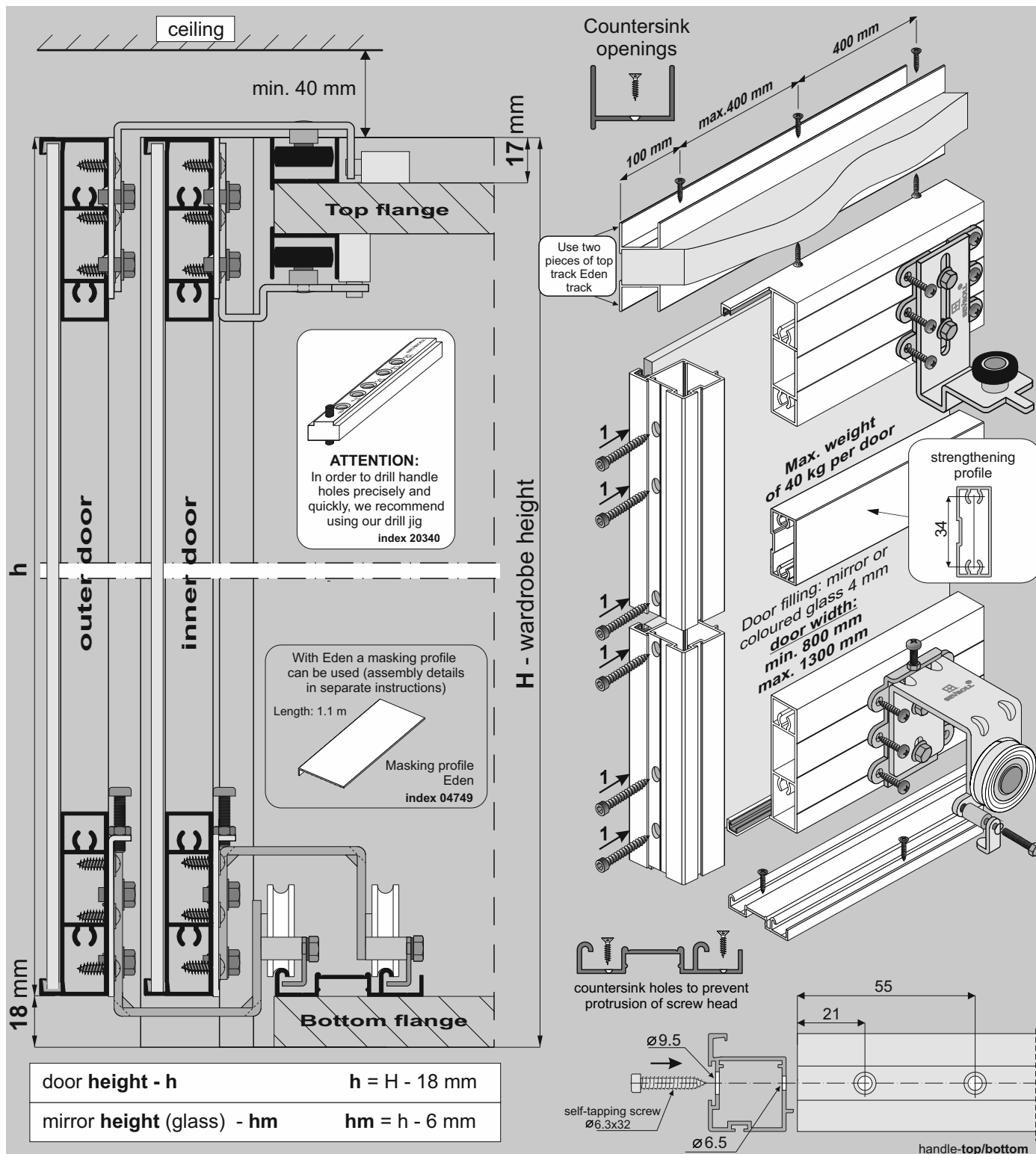

## COMPONENTS

## Handle Pax XL

L: 2.70 m, 3.00 m

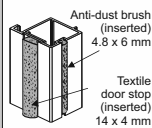

## Gasket for frame Type II



(index - 20167)

## Horizontal profile Eden XL

L: 1.70 m, 2.35 m, 3.00 m

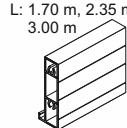
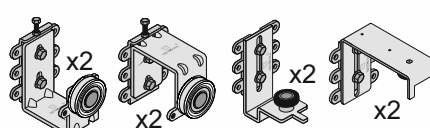
Set for sliding door Eden  
- 2 door wings (inner and outer)

x4

x4

x2

screw 3.5x20

x 4

screw M4x20

x 4

self-tapping screw 3.9x13

x 48

spring washer 4

x 4

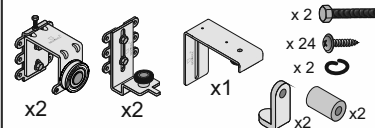
Set for third door Eden  
- 1 inner door

## Soft-close

MINI SV-25 (index: 20359-SV) x4  
or  
MINI SV-40 (index: 20260-SV)

Central SV-25 (20360-BL)  
or  
Central SV-40 (20297-BL)

x1

## Bottom track Gemini-Decor II

L: 1.70 m, 2.35 m, 3.00 m, 4.05 m, 6.00 m

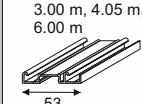

## Top track Eden

L: 1.70 m, 2.35 m, 3.00 m, 6.00 m

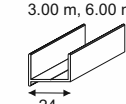

## Strengthening profile

L: 3.00 m

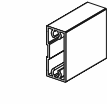

You must remember to purchase self-tapping screws to construct each door (min. 8 screws per door).



LINE

Pax XL

SYSTEM

EDEN 4 – 3 door wings

SEVROLL

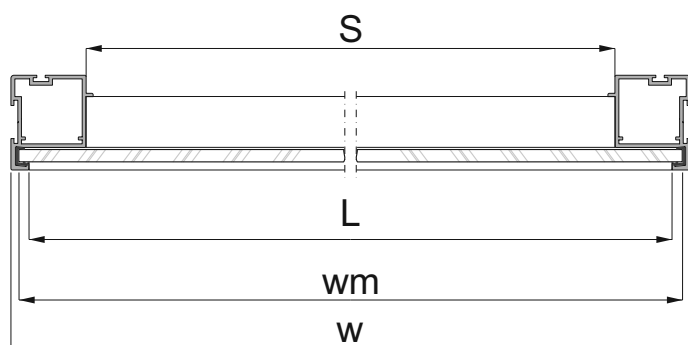
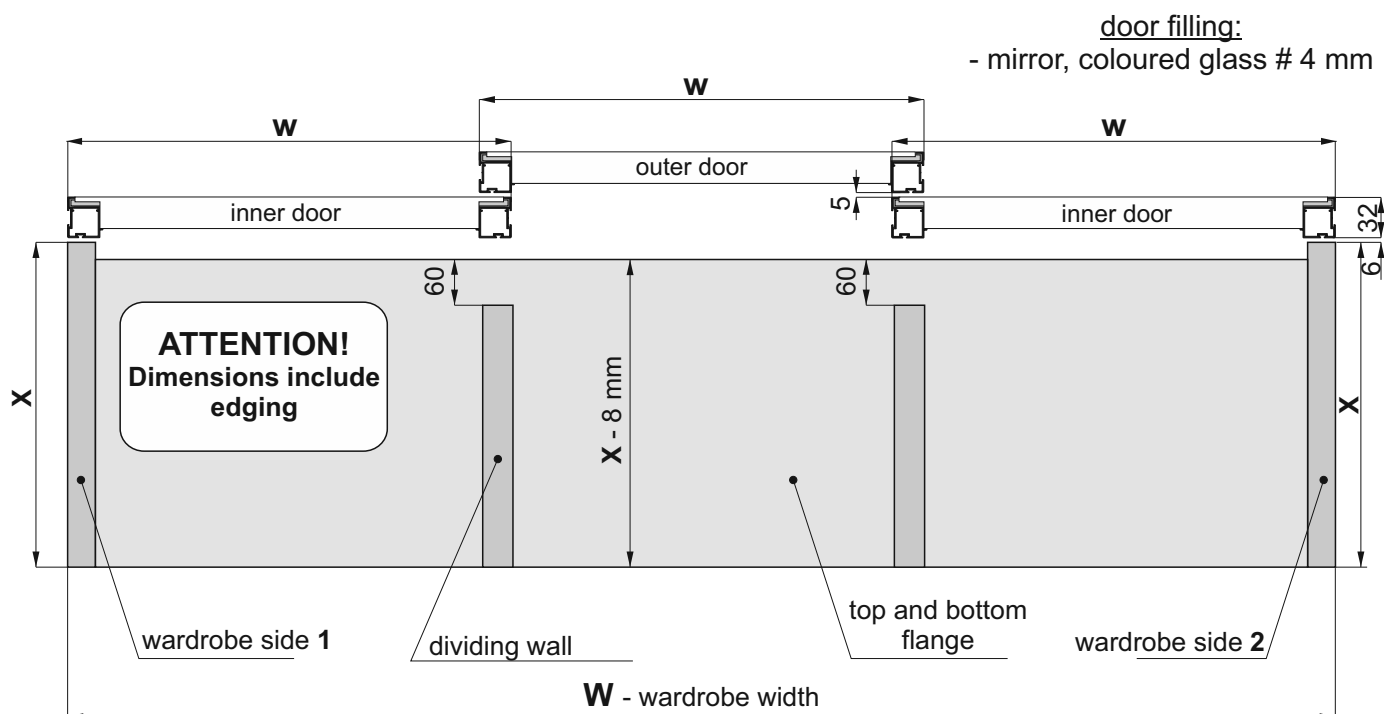

#### Installation method for fitting mirror or coloured glass 4 mm

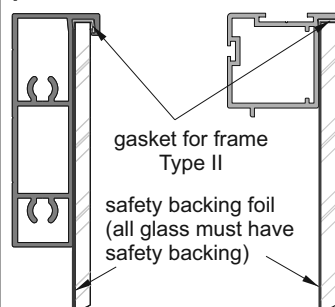
- with  
horizontal  
profile- with  
handle

**ATTENTION!**  
Due to the fact that no plinth is needed in system Eden, attention must be paid to the bottom flange being positioned level to the floor. Additionally, when using furniture slides, they should be placed along the whole length so that the bottom flange and bottom track does not bend.

Door width	$w = (W + 50 \text{ mm}) : 3$
Mirror width (glass)	$w_m = w - 6 \text{ mm}$
Horizontal profile length Eden XL	$L = w - 12 \text{ mm}$
Strengthening profile length	$S = w - 50 \text{ mm}$

#### ATTENTION!

Rear mirror / coloured glass surface must be secured with safety backing foil (excluding glass surface glued with mirror adhesive).  
The edges of glass must be polished.

#### ATTENTION

In Eden system with doors taller than 2 m it is possible for the door wing to bow +/- 5 mm

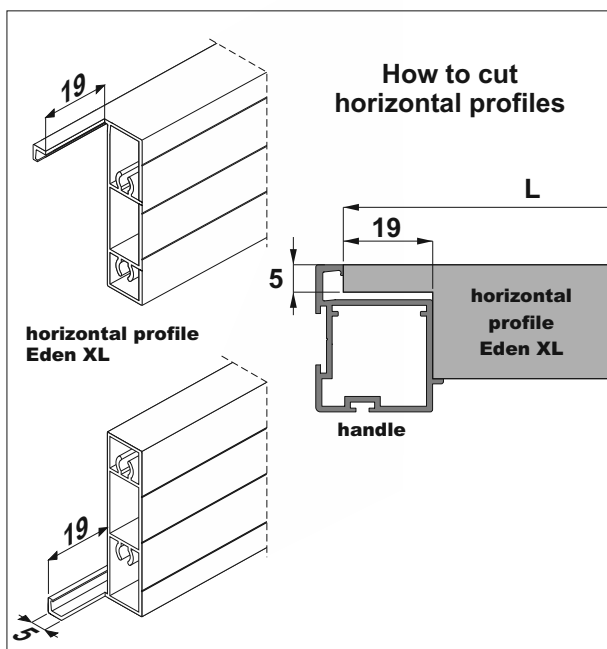



LINE

Pax XL

SYSTEM

EDEN 4 – 3 door wings

SEVROLL

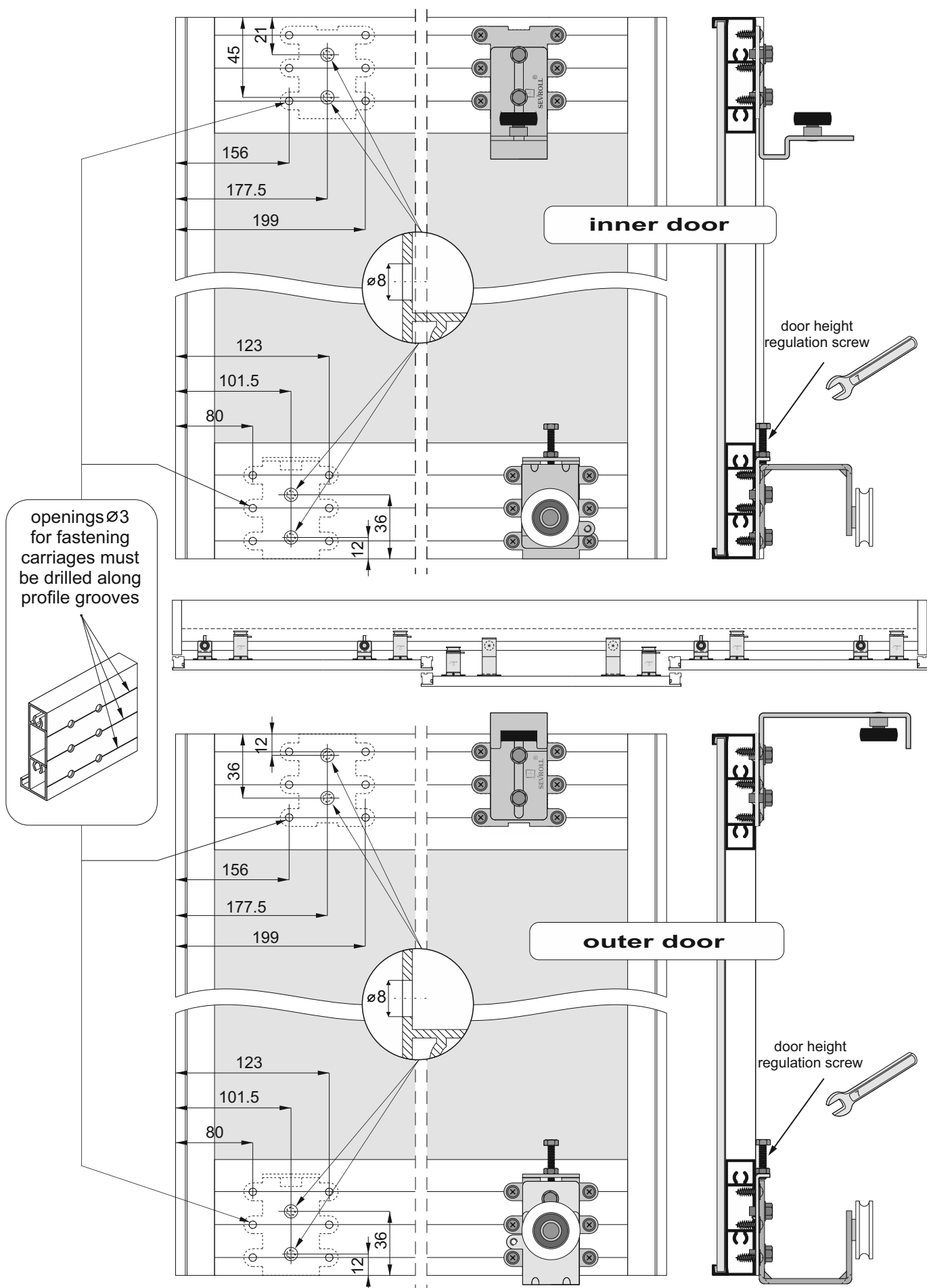



LINE

Pax XL /

SYSTEM

EDEN 4 – 3 door wings

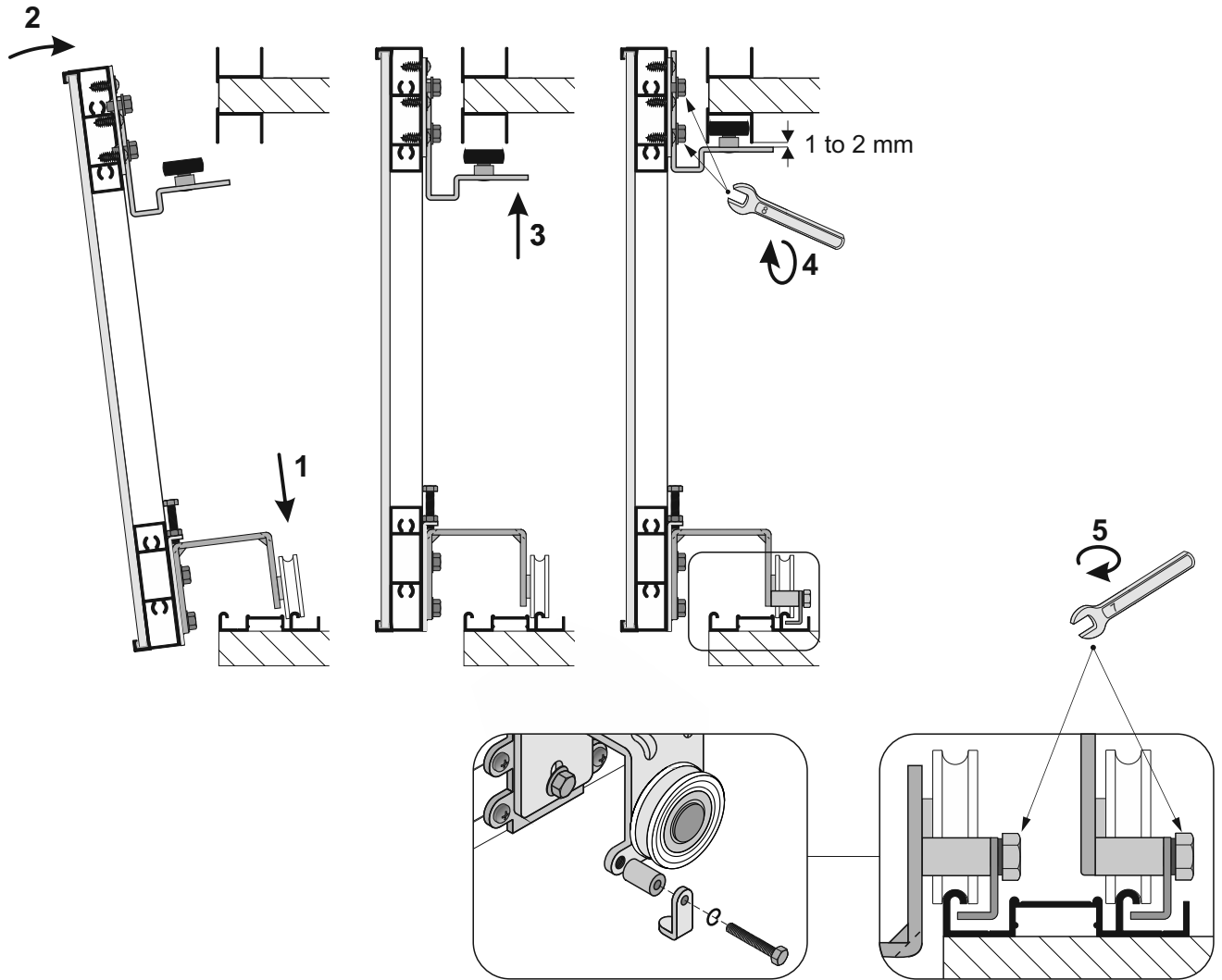
**SEVROLL****Inner door installation**

securing catch  
- fasten after door assembly

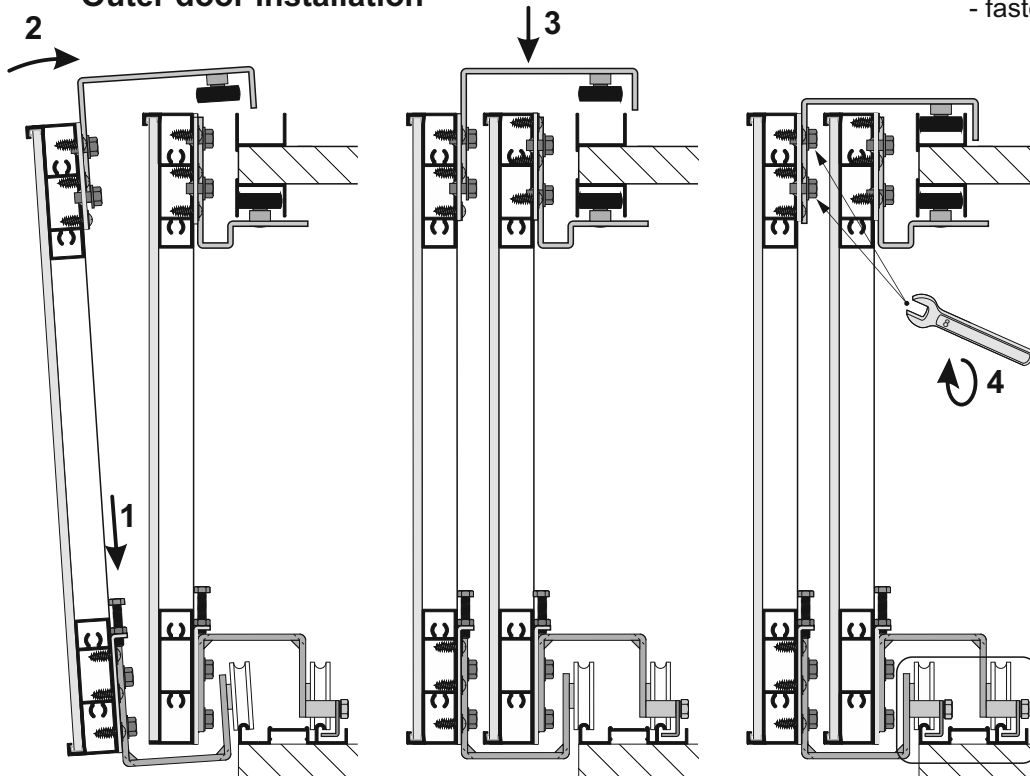
**Outer door installation**



LINE

Pax XL /

SYSTEM

EDEN 4 – 3 door wings

**SEVROLL****Soft-close installation**