

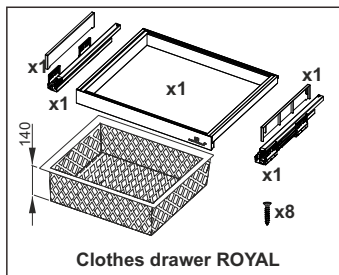

Components

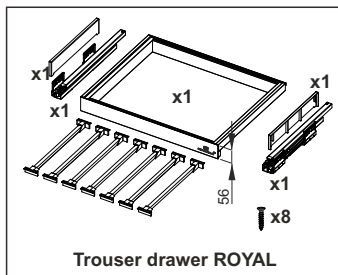

Clothes drawer ROYAL



Trousler drawer ROYAL

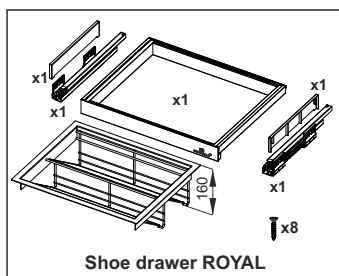

Shoe drawer ROYAL

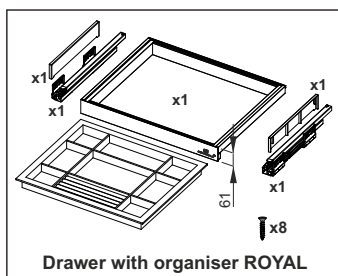

Drawer with organiser ROYAL

Note: This set includes Ø4x16 screws

Carcass dimensions

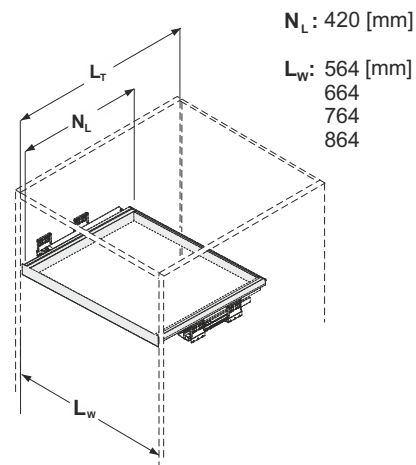

N_L - Drawer depth

L_T - Internal carcass depth min. $N_L + 5$ mm

L_W - Internal carcass segment width

1. Installation of slides

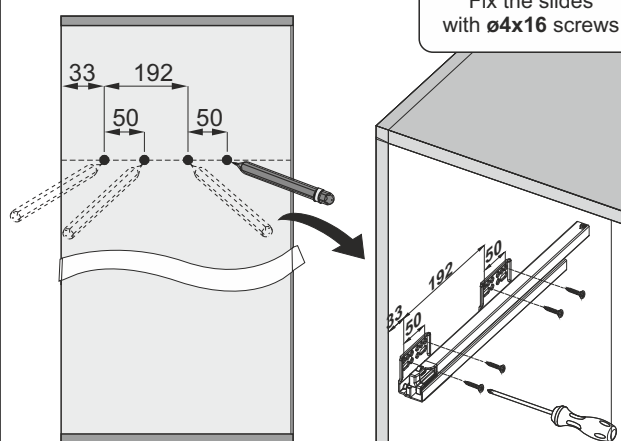

2. Installation of slides covers

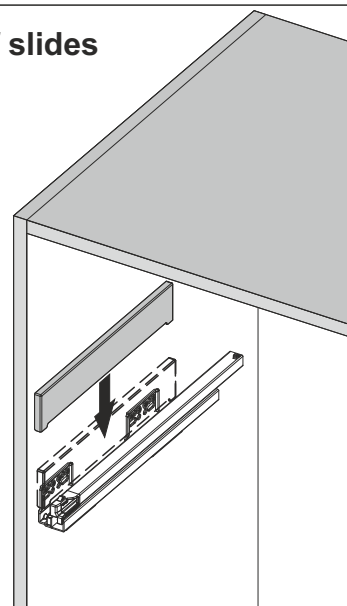

3. Regulation

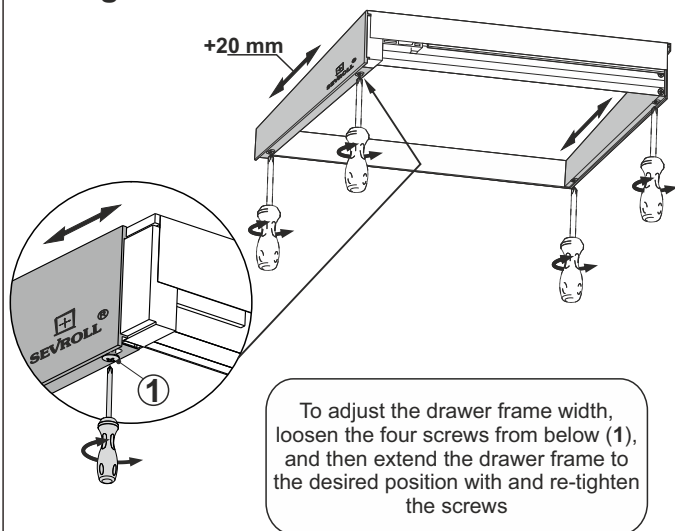

4. Installing the drawer frame on slides

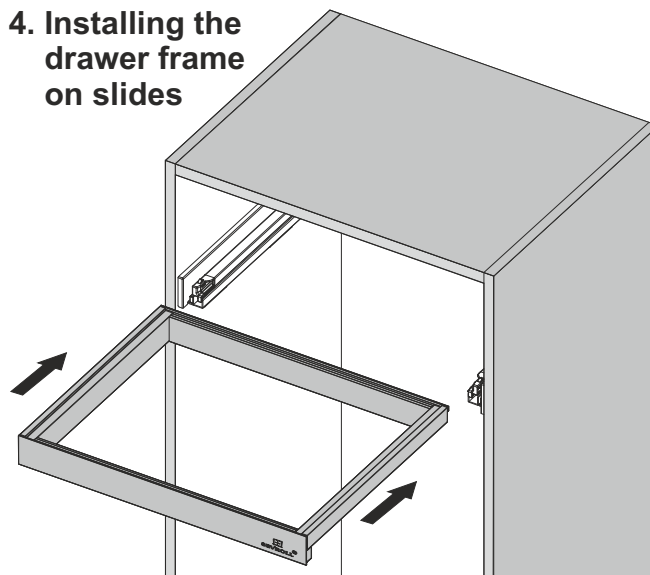



5. Drawer installation

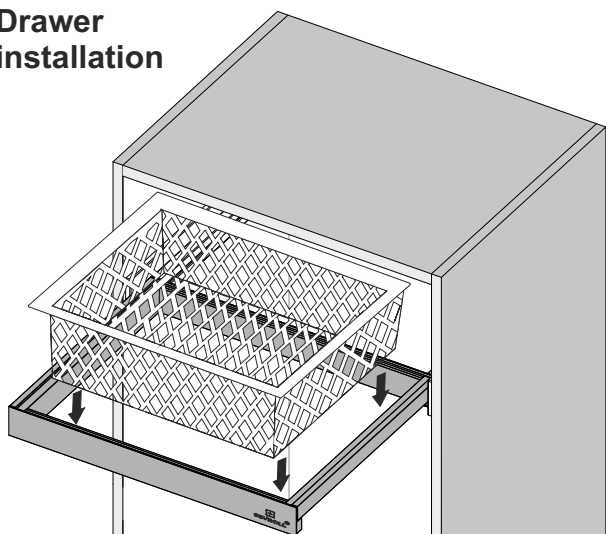

Check that the drawer operates freely and, if necessary make drawer frame adjustments

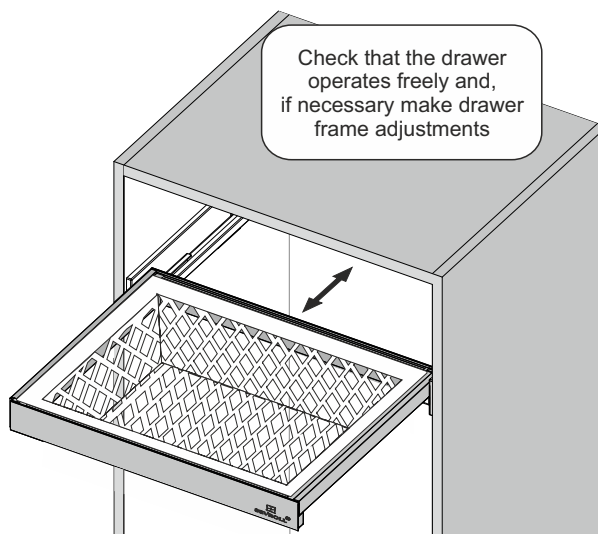

6. Drawer removal

