

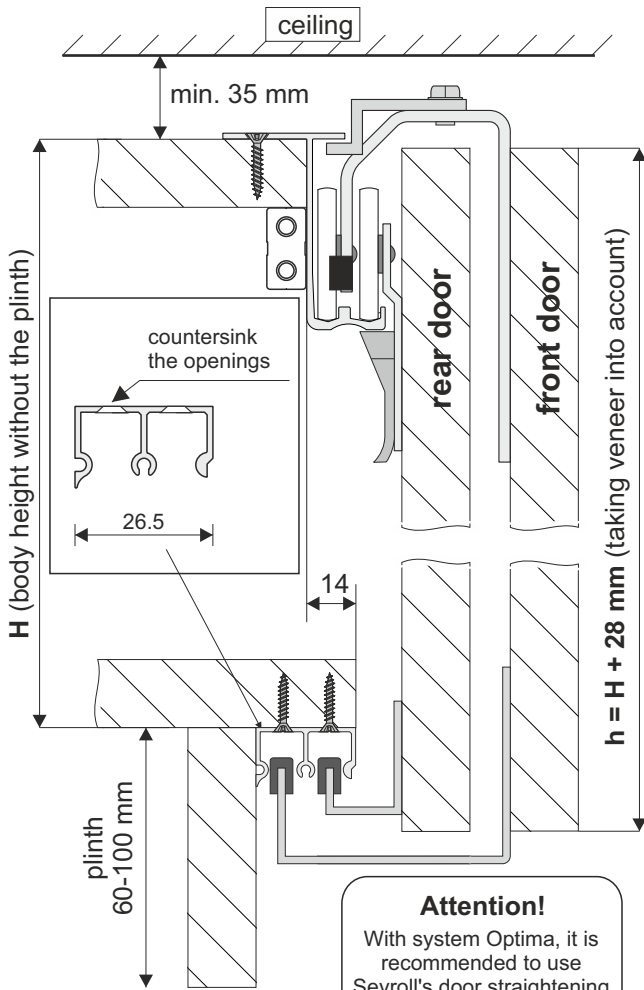

SYSTEM

OPTIMA 18 – for 3 wings



ATTENTION

Door height should be greater than body height (without the plinth) by exactly 28 mm.
 Top flange should be moved back by 13 mm in relation to the bottom flange and should be fastened firmly.
 Thickness of board: max. 20 mm.

Rear door assembly

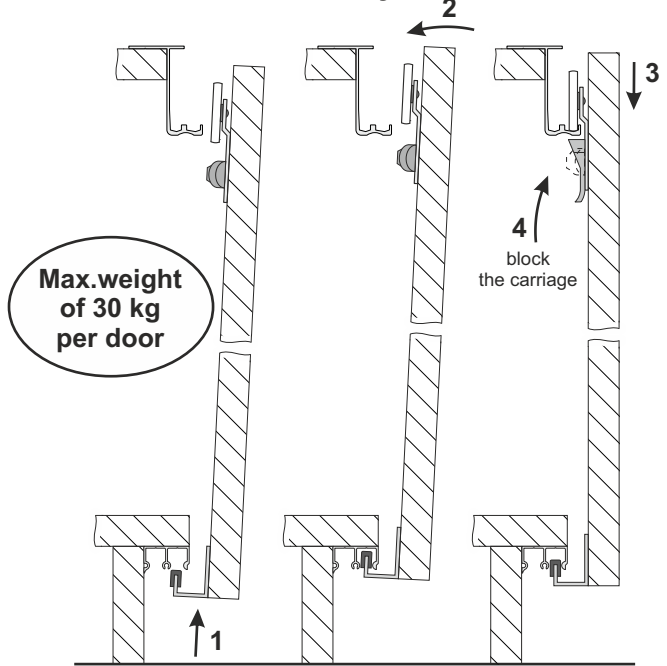

Attention!

With system Optima, it is recommended to use Sevroll's door straightening kits to eliminate the chance of door bowing

Front door assembly

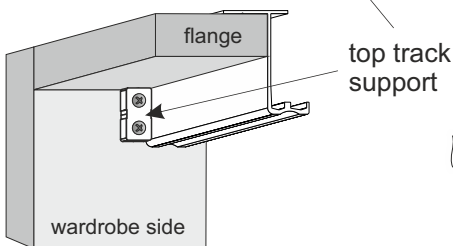
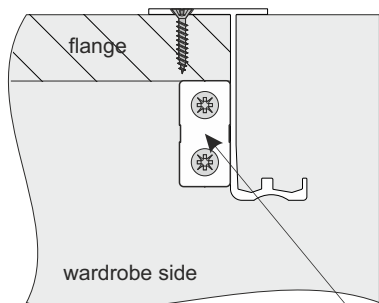
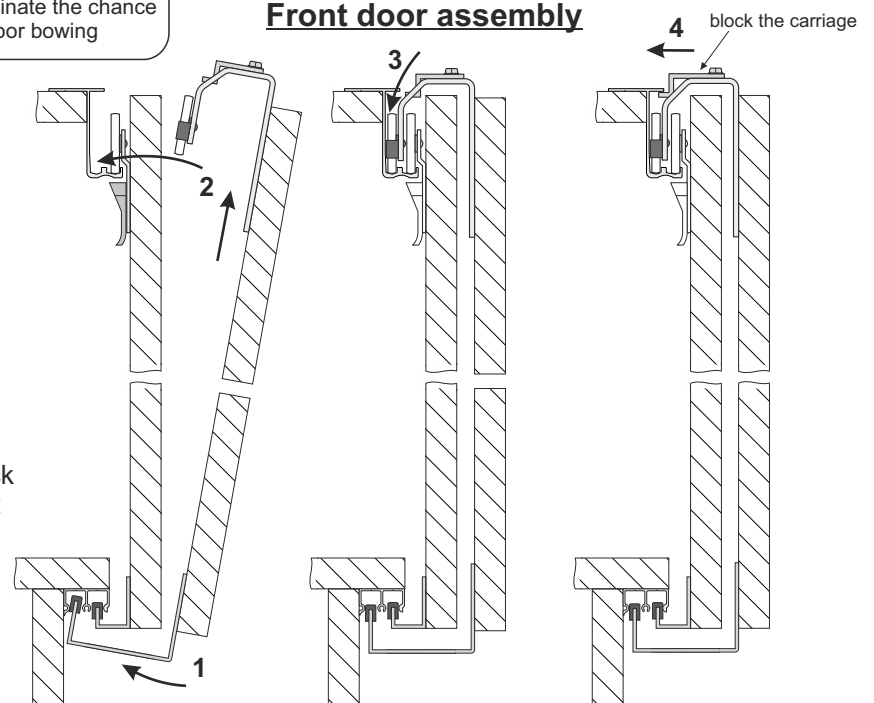

COMPONENTS

Top track Optima	Bottom track Optima	Set for sliding doors Optima II - 3 door wings	Handle Optima
L: 2.00 m, 2.40 m	L: 2.00 m, 2.40 m	2 door wings: x2, x1, x1, x2, x2, x2, x2 + 1 door wing: x1, x1, x1	L: 2.40 m
			anti-dust brush inserted 14 x 4 mm (set A)
43	26		textile door stop inserted 4 x 4.8 mm (set A)
			#16, #18



SYSTEM

OPTIMA 18 – for 3 wings



board width calculation

door without vertical proles (taking edging into account)

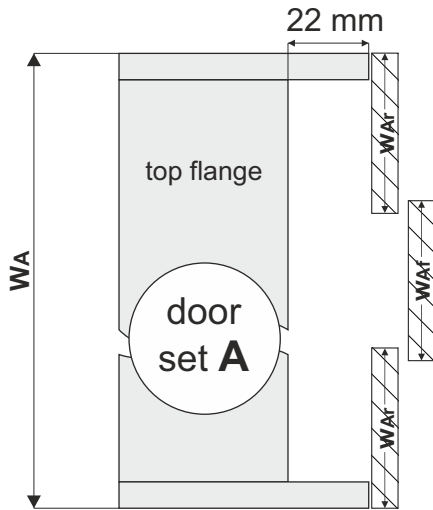

$$W_{Af} = W_{Ar} = (W_A + 40 \text{ mm}) : 3$$

door with vertical proles (handles)

rear door - 1 handle
front door - 2 handles

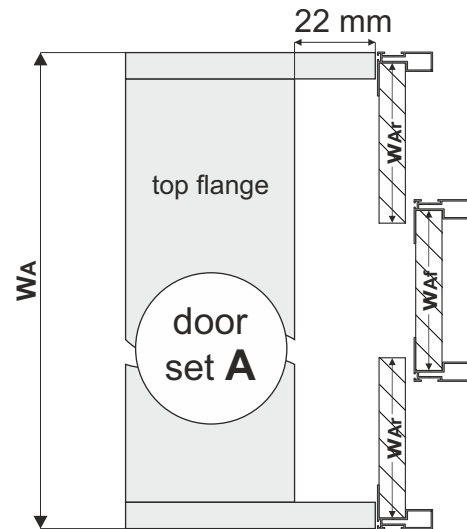

$$W_{Af} = [(W_A + 40 \text{ mm}) : 3] - 14$$

$$W_{Ar} = [(W_A + 40 \text{ mm}) : 3] - 7$$

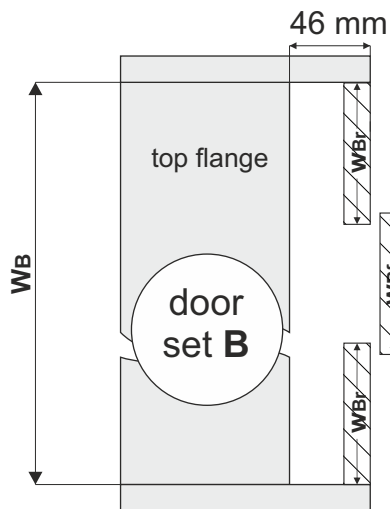

$$W_{Bf} = W_{Br} = (W_B + 40 \text{ mm}) : 3$$

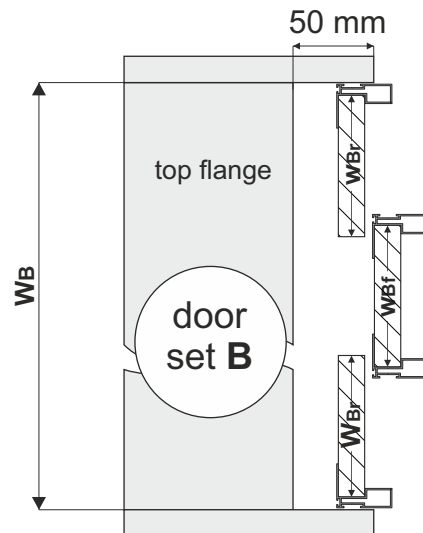

$$W_{Bf} = [(W_B + 40 \text{ mm}) : 3] - 14$$

$$W_{Br} = [(W_B + 40 \text{ mm}) : 3] - 7$$

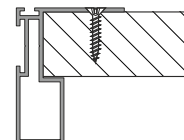

handle to be fastened with a minimum of 4 screws



SYSTEM

OPTIMA 18 – for 3 wings



Fastening of carriages and guides to the rear door

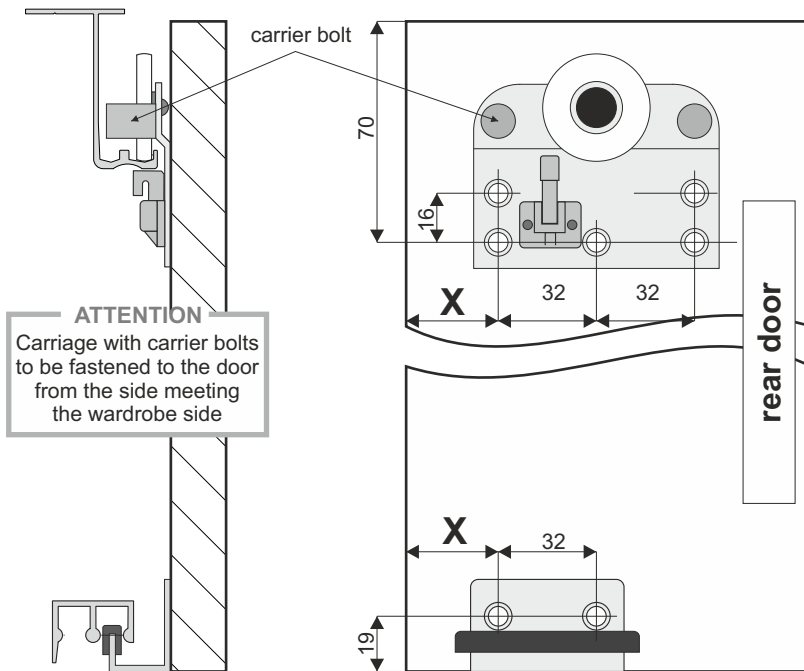

Fastening of stopper to the top track

rear door (set A and B)
door without and with vertical proles (handles)

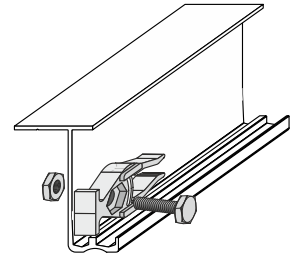

drill opening in track $\varnothing 6$

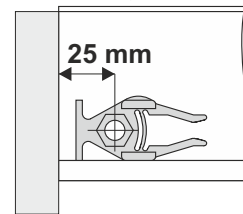

Fastening of carriages and guides to the front door

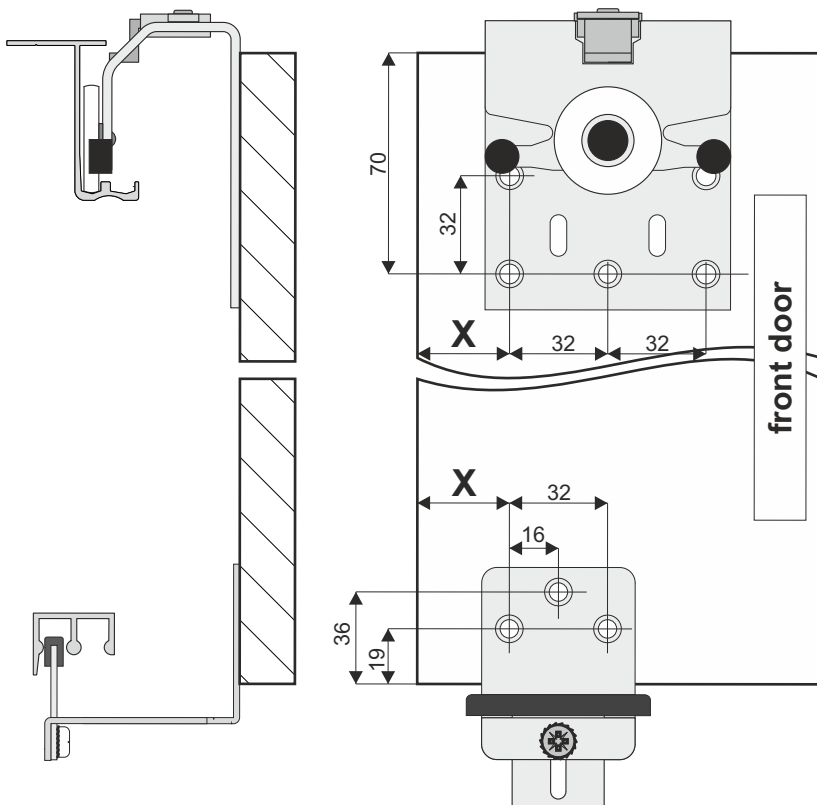

front door
(fasten after door assembly)

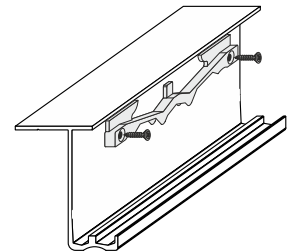

use self-tapping screw $\varnothing 3.5$
or drill opening in track $\varnothing 2.5$
and use Unix screw $\varnothing 3.5$

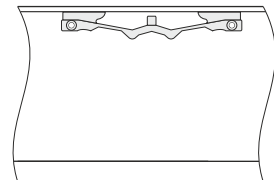

distance	door without vertical profiles		door with vertical profiles (handles)	
	door set A	door set B	door set A	door set B
X	58 mm	40 mm	51 mm	31 mm



Optionally, instead of stoppers, soft-closes **Optima** can be used purchased separately (only for rear door)



SYSTEM

OPTIMA 18 – for 3 wings



Option with mirror (only available for front door wing)
door set A and B

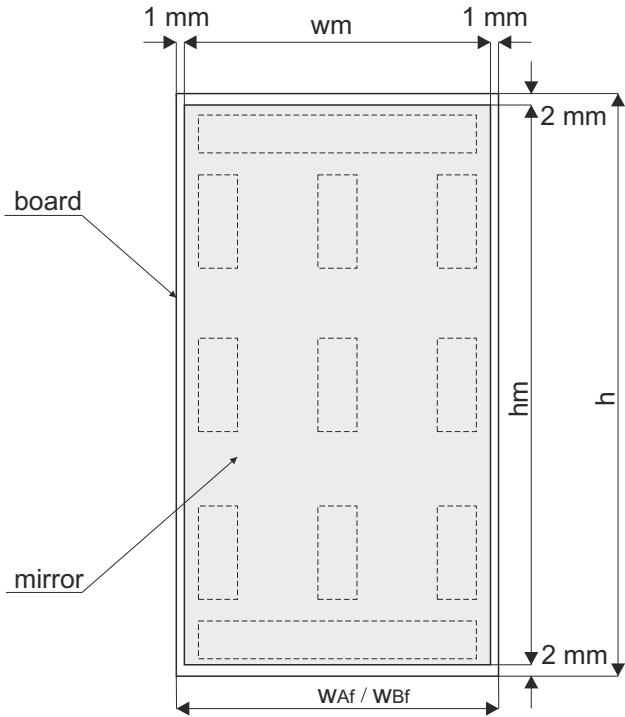

Broken line indicates recommended positioning of double-sided tape

ATTENTION:
Board to mirror contact area should be free from dirt and grease before applying double-sided tape

mirror dimensions

wm = $W_{af} / W_{bf} - 2 \text{ mm}$

hm = $h - 4 \text{ mm}$

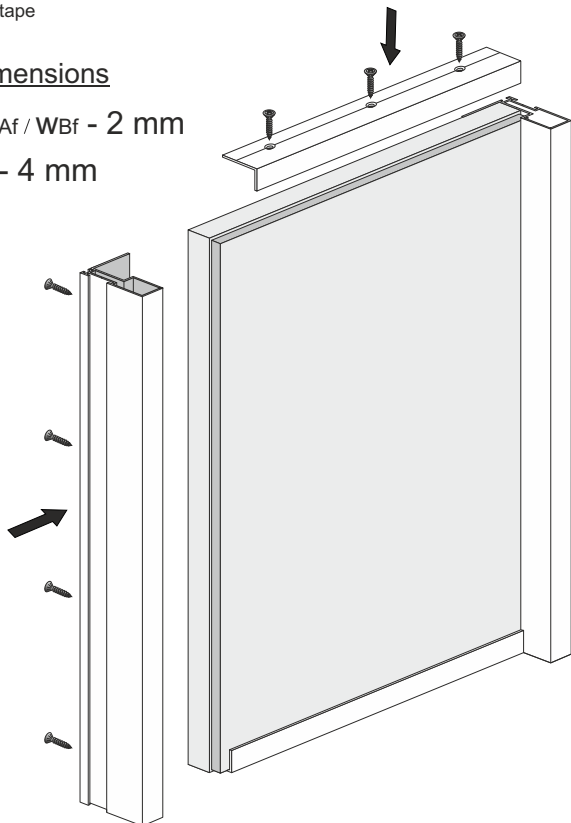

ATTENTION!

The usage of angle section requires the handle to be 3 mm longer than board size (protruding by: 1.5 mm - top, 1.5 mm - bottom)

Use angle section Mini

Fitting of handle OPTIMA # 16

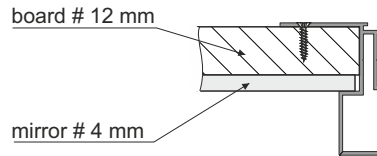

Angle section MINI assembly

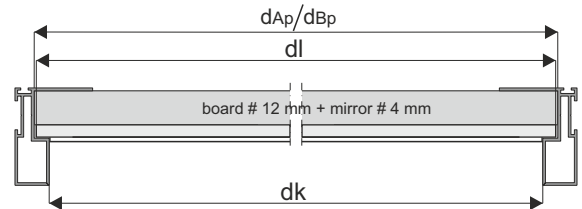
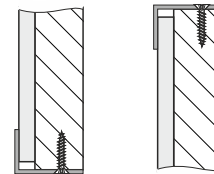

la - angle section Mini length

la = $w_{af} - 12 \text{ mm}$



for aesthetic reasons, the angle section length should be decided after handle fitting

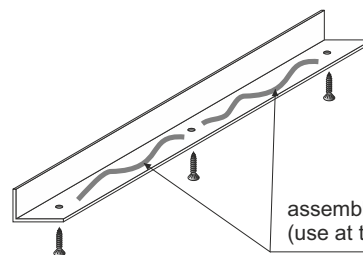

assembly adhesive (use at the bottom of the door)

ATTENTION!

Angle section must be fastened to board with a minimum of 3 screws 3 x 25.