

COMPONENTS

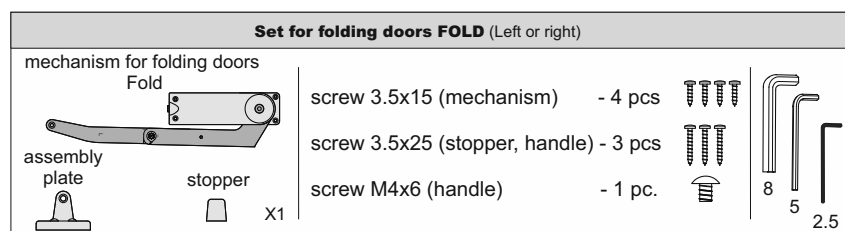

EXTRA COMPONENTS

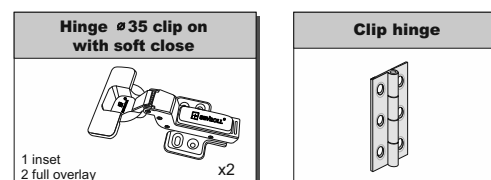



SYSTEM

DS FOLD

SEVROLL

step 1 and 3

unblock / block folding door mechanism's arm

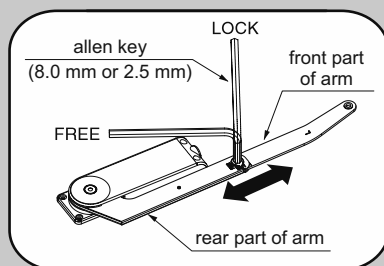
**step 2**

set required length of folding door mechanism's arm

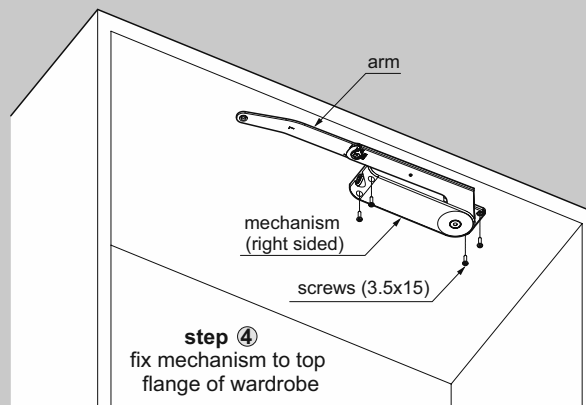
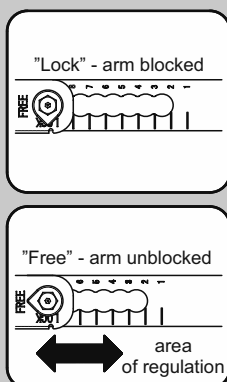
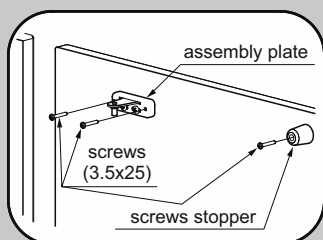
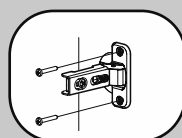
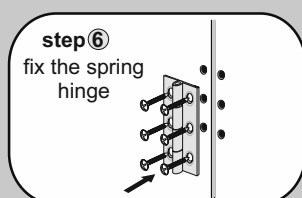
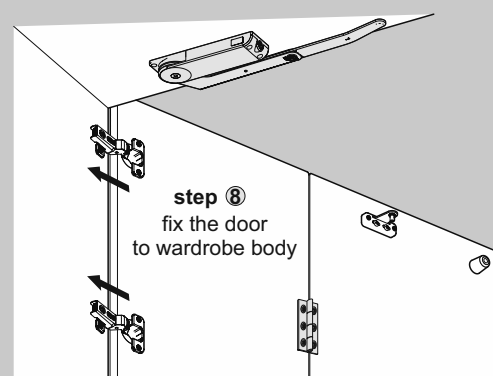
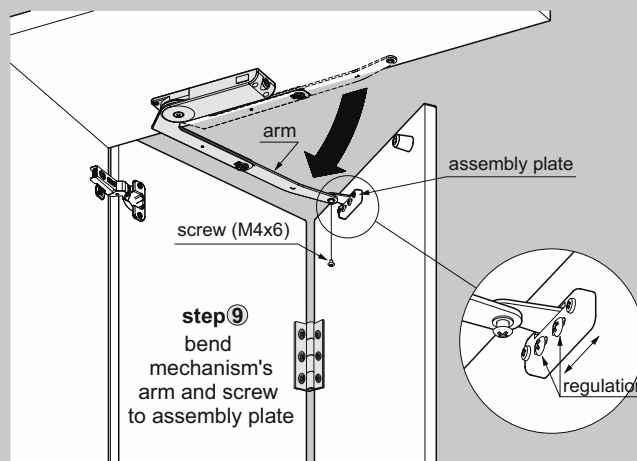
**step 4**
fix mechanism to top flange of wardrobe**step 5**
fix stopper and assembly plate**step 7**
fix the hinges**step 6**
fix the spring hinge**step 8**
fix the door to wardrobe body**step 9**
bend mechanism's arm and screw to assembly plate

Recommended number of hinges is dependent on board height and equals:

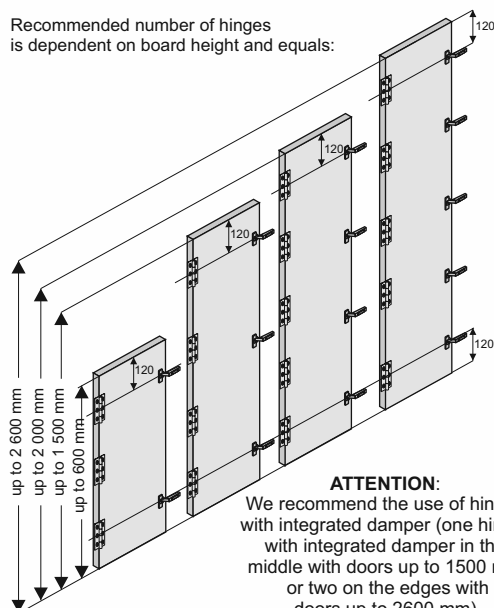
**ATTENTION:**

We recommend the use of hinges with integrated damper (one hinge) with integrated damper in the middle with doors up to 1500 mm or two on the edges with doors up to 2600 mm)

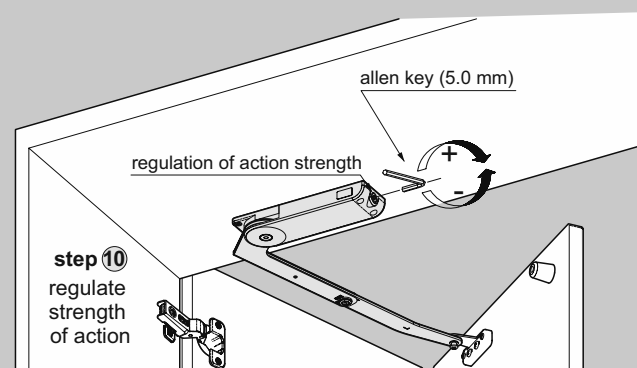
**step 10**
regulate strength of action