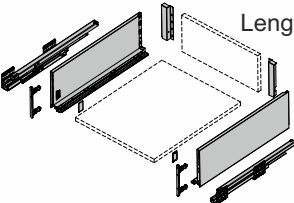
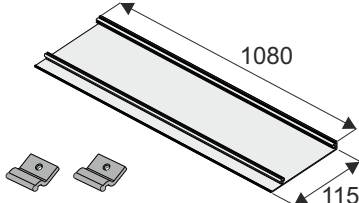
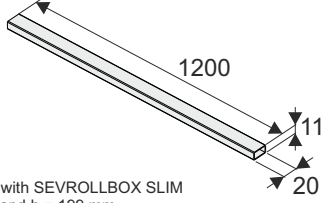
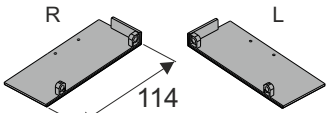
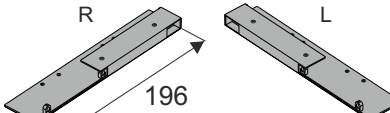
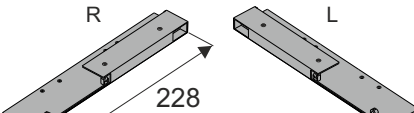
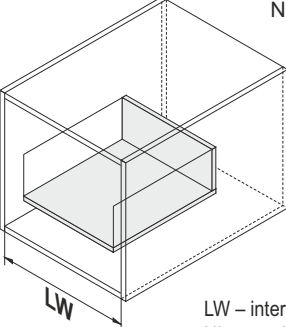
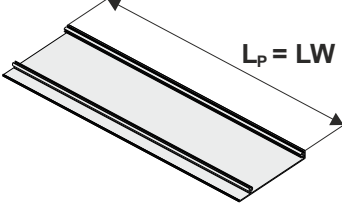
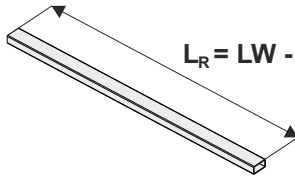
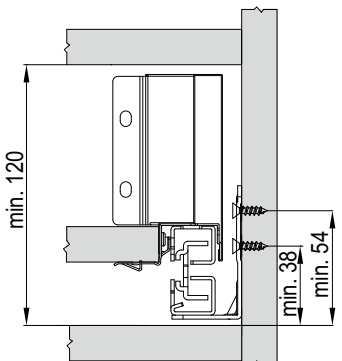
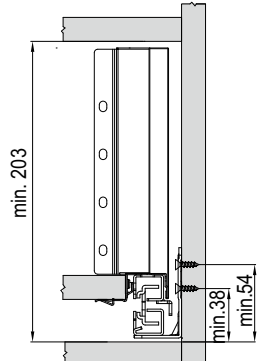
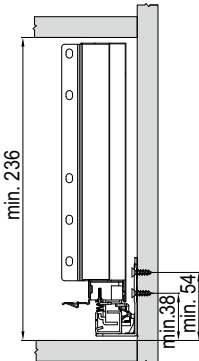
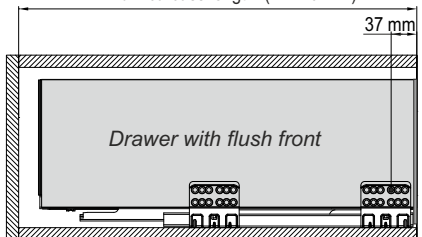
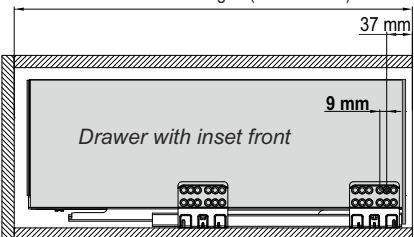

**Components:**

<p>Drawer SEVROLLBOX SLIM h = 84 mm / h = 167 mm / h = 199 mm</p>  <p>Length: 270 [mm] 300 350 400 450 500 550</p>	<p>Universal drawer front base profile for internal drawer SEVROLLBOX SLIM</p> 	<p>Universal drawer front railing for internal drawer SEVROLLBOX SLIM</p>  <p>Only for use with SEVROLLBOX SLIM h = 167 mm and h = 199 mm</p>
<p>Set for internal drawer SEVROLLBOX SLIM h = 84 mm</p>  <p>4x20 Screws for "drawer front base profile"</p> <p>M3x7 Screws for "Set for internal drawer"</p>	<p>Set for internal drawer SEVROLLBOX SLIM h = 167 mm</p>  <p>4x20 Screws for "drawer front base profile"</p> <p>M3x7 Screws for "Set for internal drawer"</p>	<p>Set for internal drawer SEVROLLBOX SLIM h = 199 mm</p>  <p>4x20 Screws for "drawer front base profile"</p> <p>M3x7 Screws for "Set for internal drawer"</p>

Cutting dimensions of profiles		
 <p>NL : 270 [mm] 300 350 400 450 500 550</p> <p>LW – internal width of carcass NL – nominal length of the drawer</p>	<p>Universal drawer front base profile</p>  <p><math>L_p = LW - 100 \text{ mm}</math></p>	<p>Universal drawer front railing</p>  <p><math>L_R = LW - 87 \text{ mm}</math></p>
<p>Calculations for the back wall and base of the drawer can be found in the instructions SEVROLLBOX SLIM</p>		

Mounting dimensions		
<p>SEVROLLBOX SLIM h = 84 mm</p> 	<p>SEVROLLBOX SLIM h = 167 mm</p> 	<p>SEVROLLBOX SLIM h = 199 mm</p> 
<p>minimum carcass length: (NL + 3 mm)</p>  <p>Drawer with flush front</p> <p>The front of the drawer sits level with the carcass edges</p>	<p>minimum carcass length: (NL + 12 mm)</p>  <p>Drawer with inset front</p> <p><b>ATTENTION!</b> To ensure that the drawers cover the high front applied, the guides should be taken back by 9 mm (one hole in the guide) into the carcass</p>	

## Installing the drawer front for SEVROLLBOX SLIM h = 84 mm

**ATTENTION!** Use the drawer front catches supplied with your Sevrollbox Slim drawer h = 84 mm

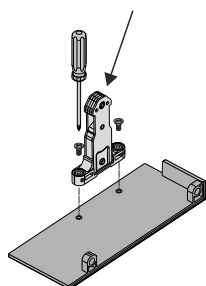

1

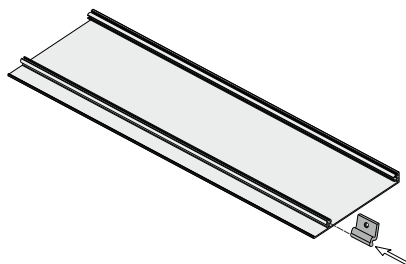

2

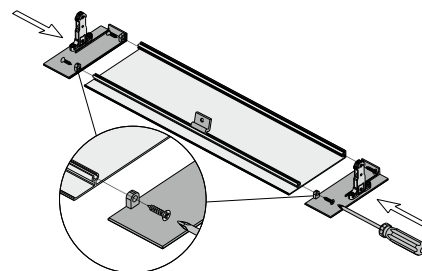

3

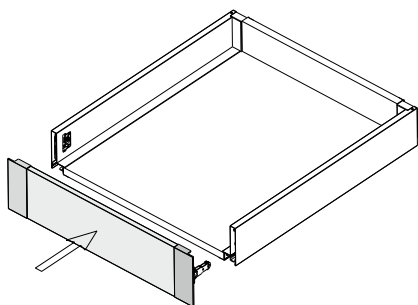

4

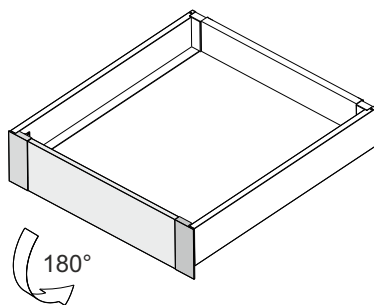

5

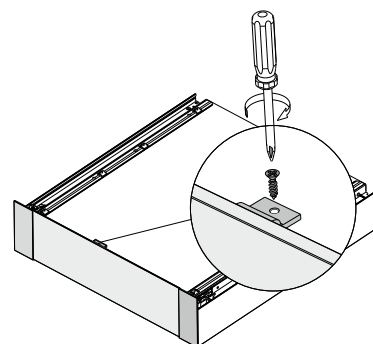

6

## Installing the drawer front for SEVROLLBOX SLIM h = 167 mm and h = 199 mm

**ATTENTION!** Use the drawer front catches supplied with your Set for internal drawer SEVROLLBOX SLIM h = 167 mm and h = 199 mm

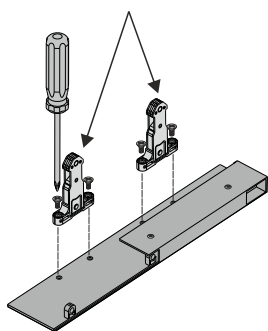

1

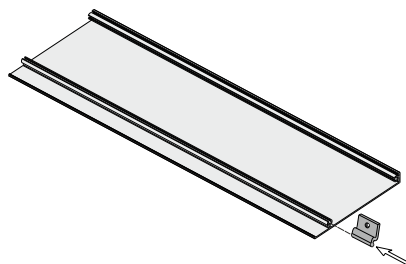

2

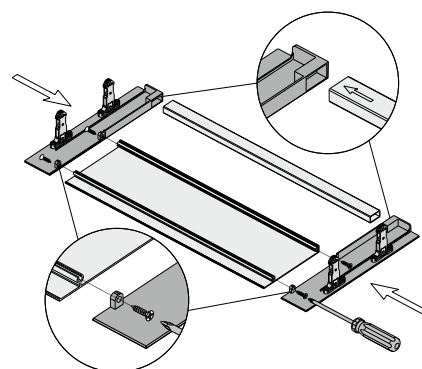

3

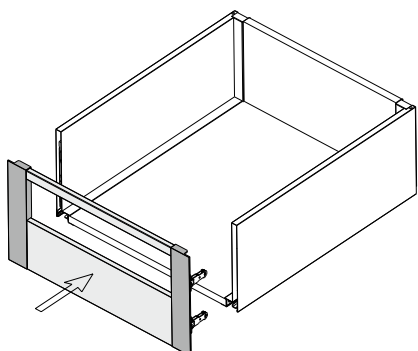

4

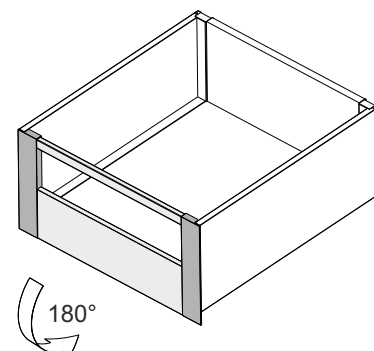

5

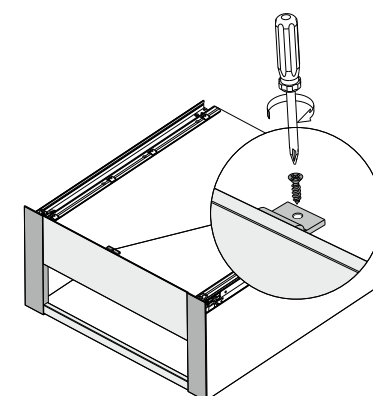

6