



LINE

Pax XL

SYSTEM

EDEN 4 – 2 door wings



SEVROLL®

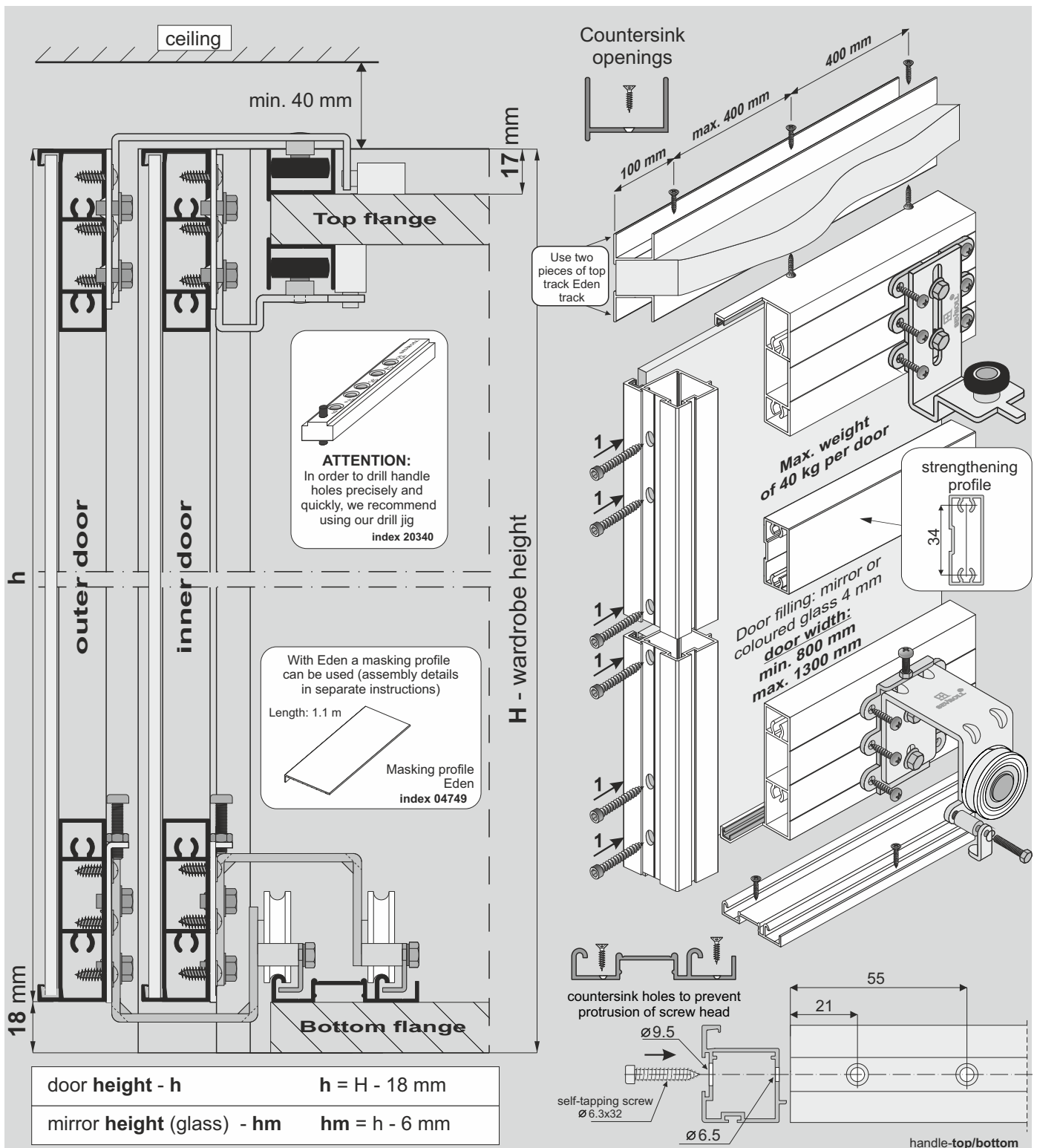

## COMPONENTS

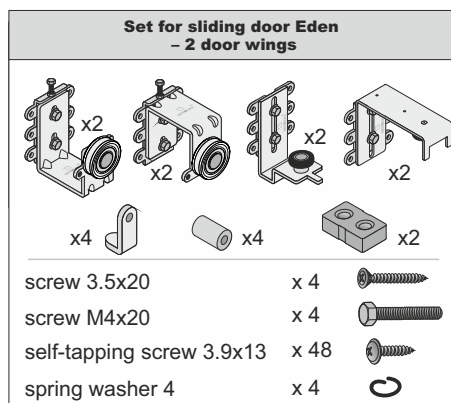
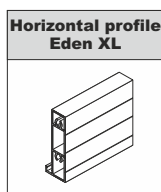
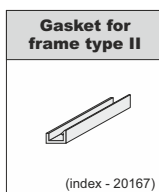
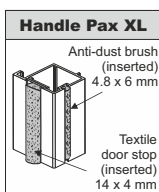

You must remember to purchase self-tapping screws to construct each door (min. 8 screws per door).

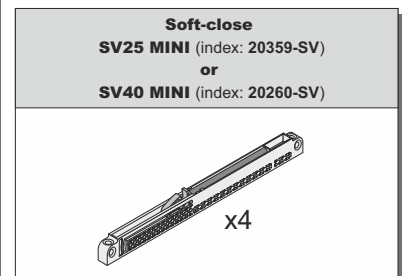
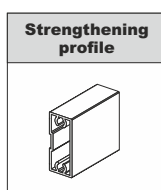
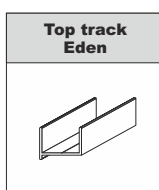
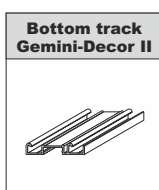



LINE

Pax XL

SYSTEM

EDEN 4 – 2 door wings



SEVROLL®

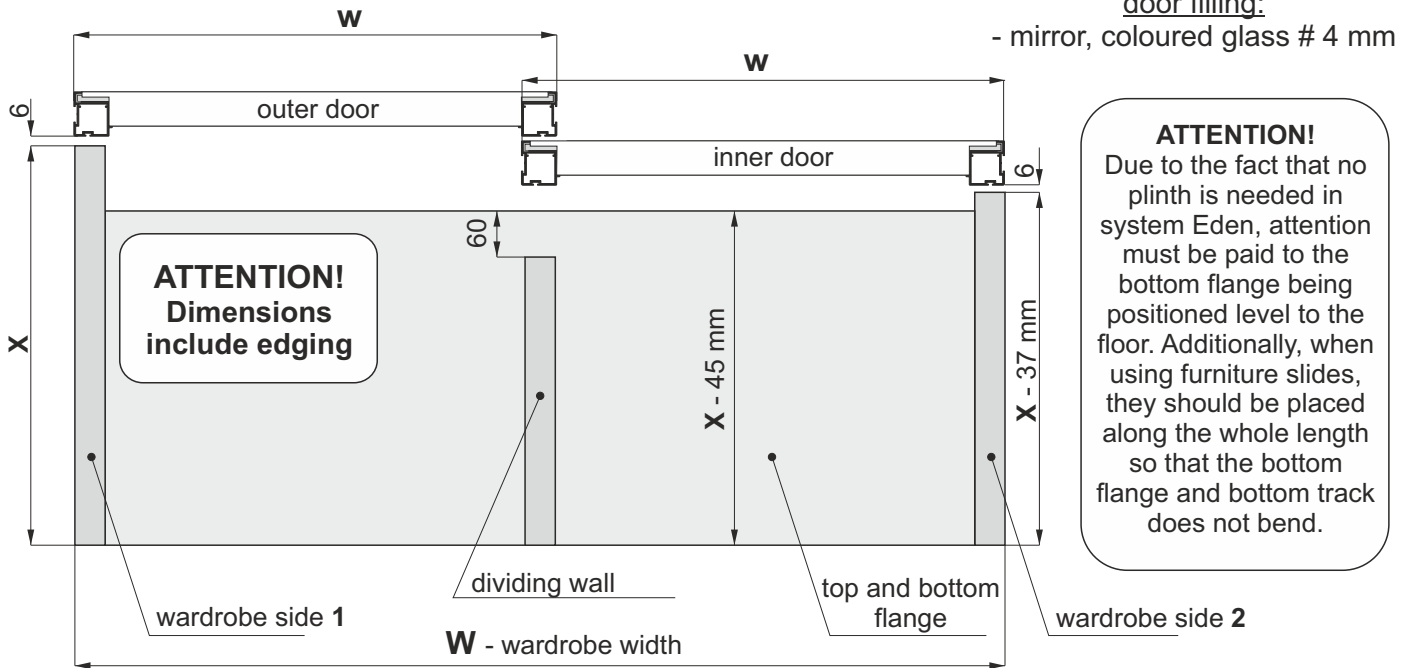

### Installation method for fitting mirror or coloured glass 4 mm

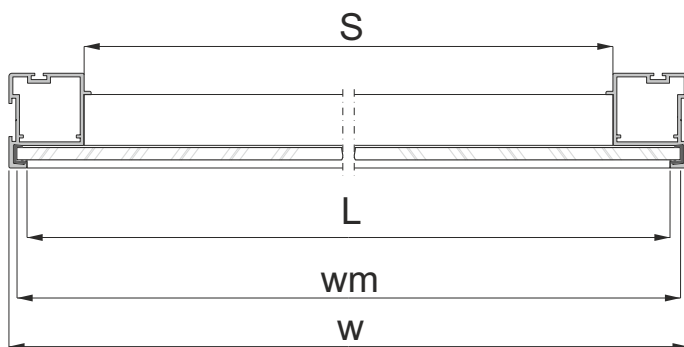

- with horizontal profile

- with handle

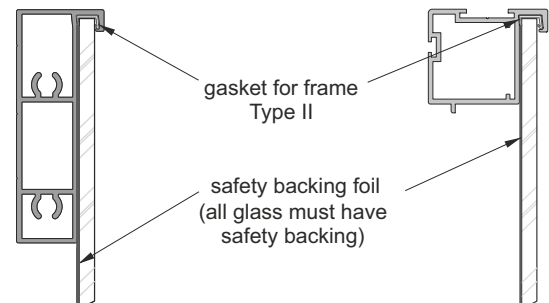

|                                   |                               |
|-----------------------------------|-------------------------------|
| Door width                        | $w = (W + 25 \text{ mm}) : 2$ |
| Mirror width (glass)              | $w_m = w - 6 \text{ mm}$      |
| Horizontal profile Eden XL length | $L = w - 12 \text{ mm}$       |
| Strengthening profile length      | $S = w - 50 \text{ mm}$       |

### ATTENTION!

Rear mirror / coloured glass surface must be secured with safety backing foil (excluding glass surface glued with mirror adhesive).  
The edges of glass must be polished.

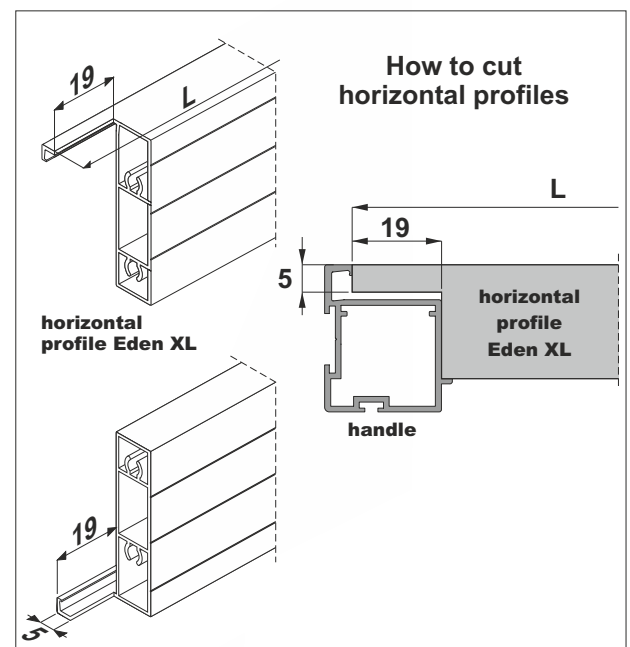



LINE

Pax XL

SYSTEM

EDEN 4 – 2 door wings



SEVROLL®

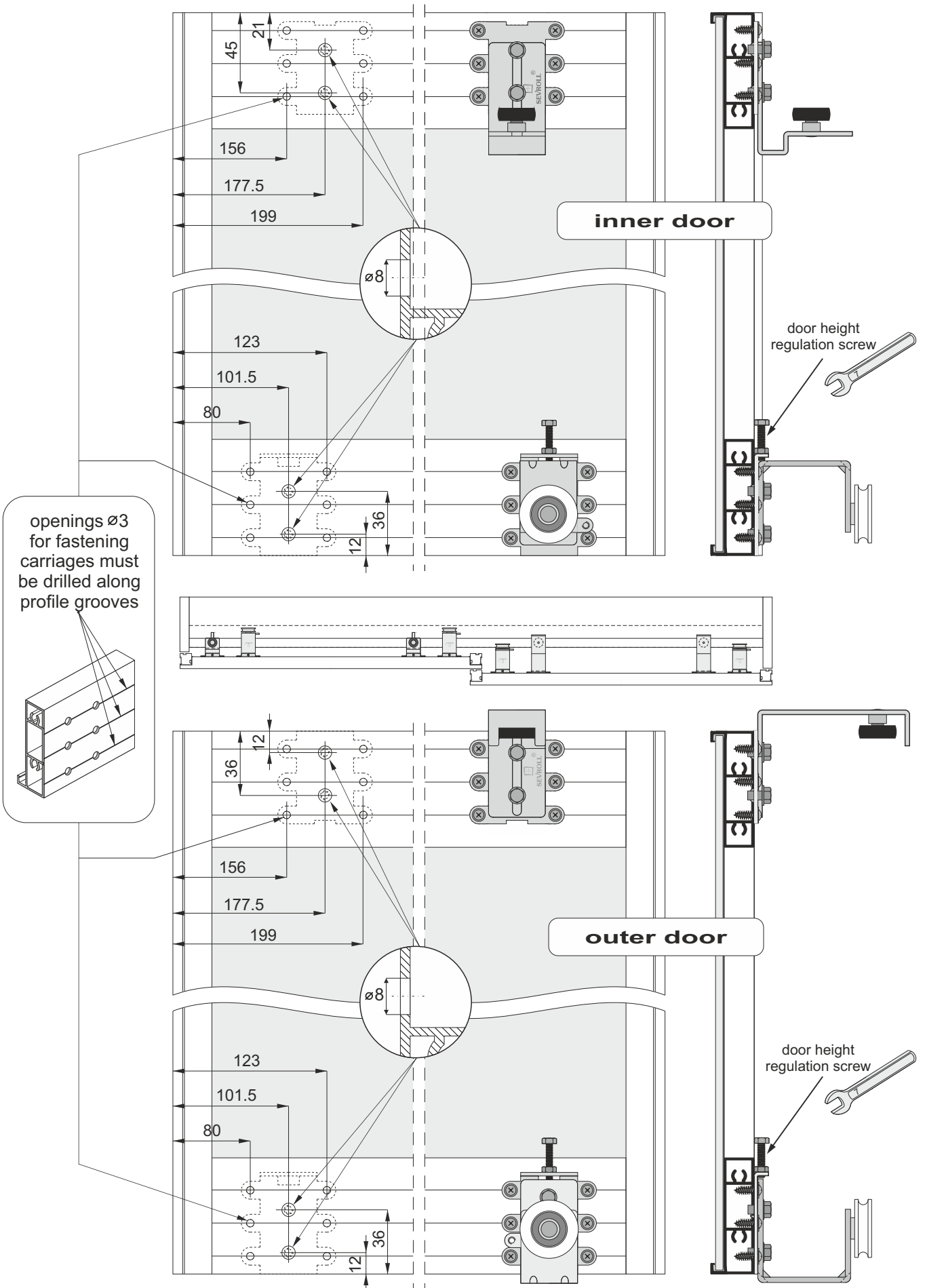



LINE

Pax XL

SYSTEM

EDEN 4 – 2 door wings



SEVROLL®

### Inner door installation

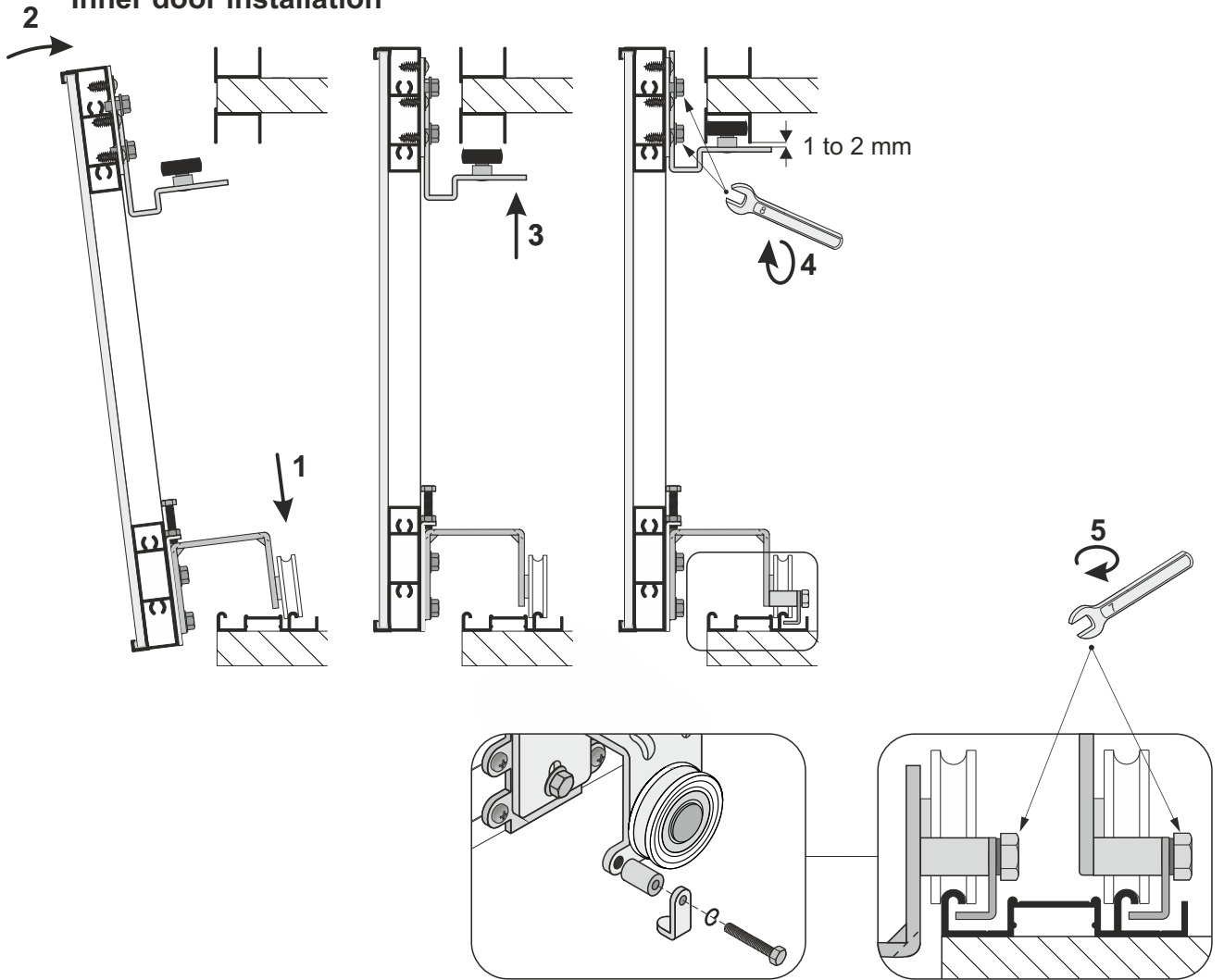

### Outer door installation

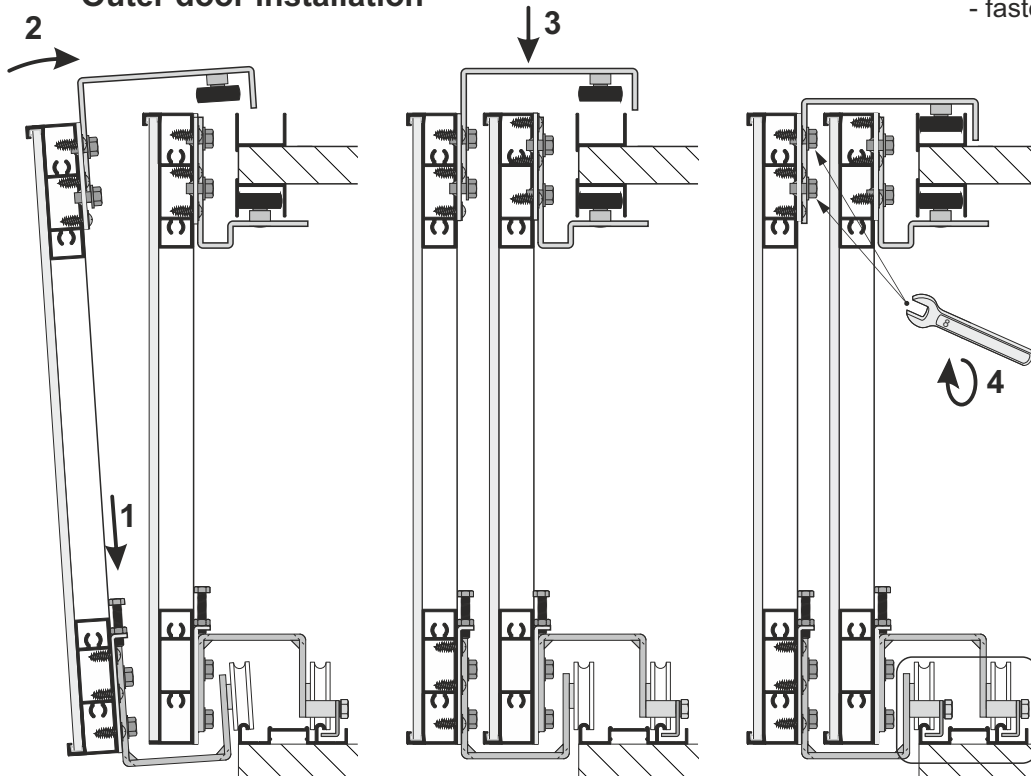



### Soft-close installation

