

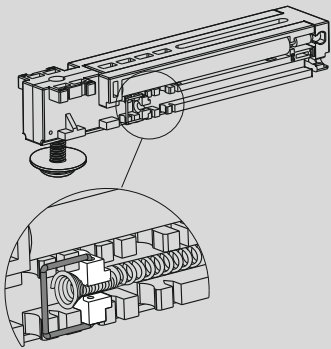

Montaż samodomykacza Herakles 40 kg lub 80 kg w systemie HERAKLES

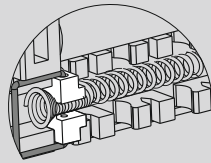

Regulation of the Herakles soft-closer



ATTENTION!
If the door soft-closes too slowly, increase the tension of the soft-close spring

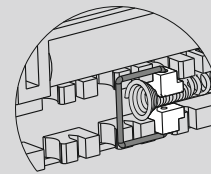



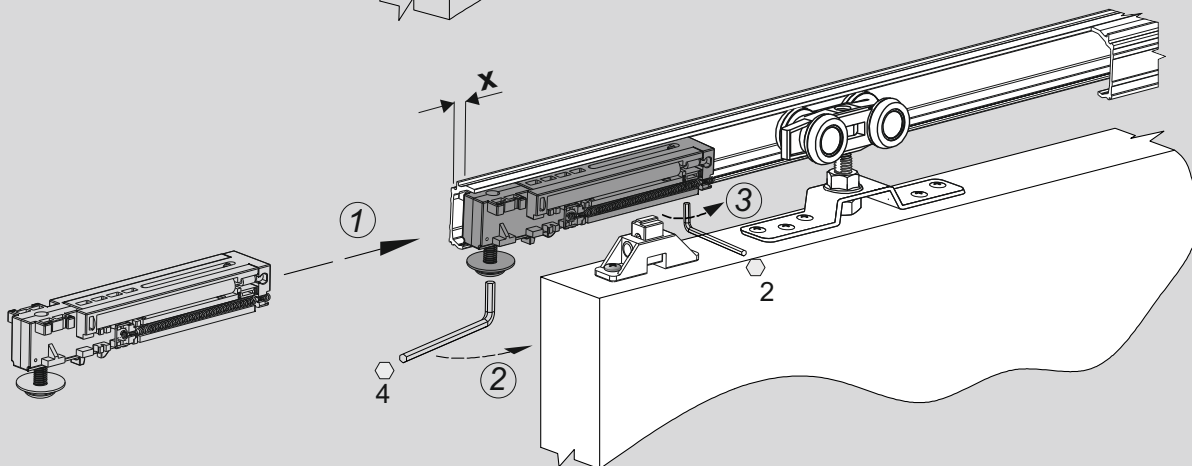
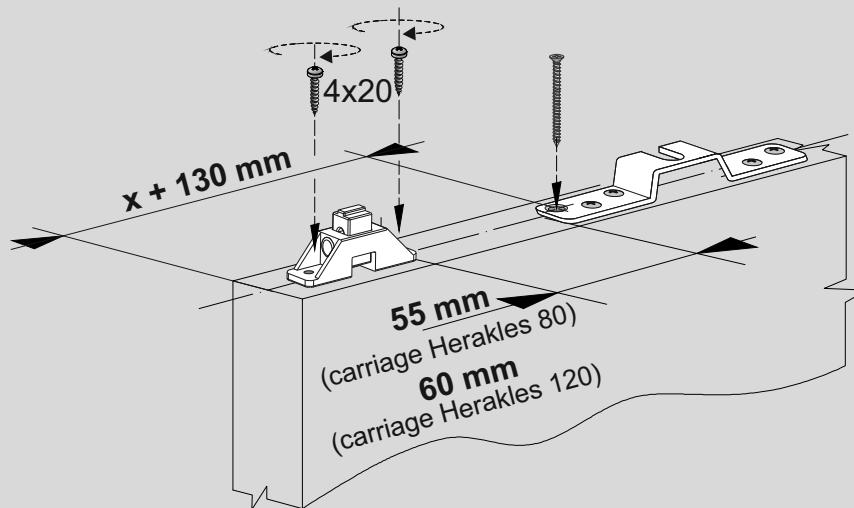

ATTENTION!
If the door soft-closes too quickly, decrease the tension of the soft-close spring

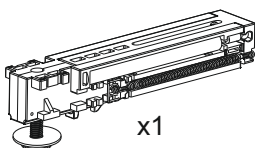
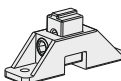

COMPONENTS

Soft-close for HERAKLES 40 kg or 80 kg top hung doors – set

 x1 Soft-close Herakles 40 kg or 80 kg	 x1 Herakles activator	 Ø 4 x 20 x2	 Allen key 4 mm
			 Allen key 2.5 mm
			 Allen key 2 mm

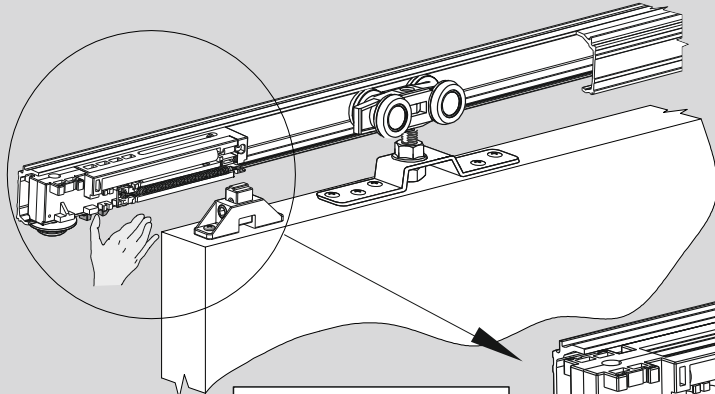

ATTENTION!
The soft-close catch
should be loaded
before inserting the door.

UWAGA!
Naciągnięcie wychwyty samodomykacza
możliwe jest dopiero po wkręceniu
wkrętu dociskowego w tor

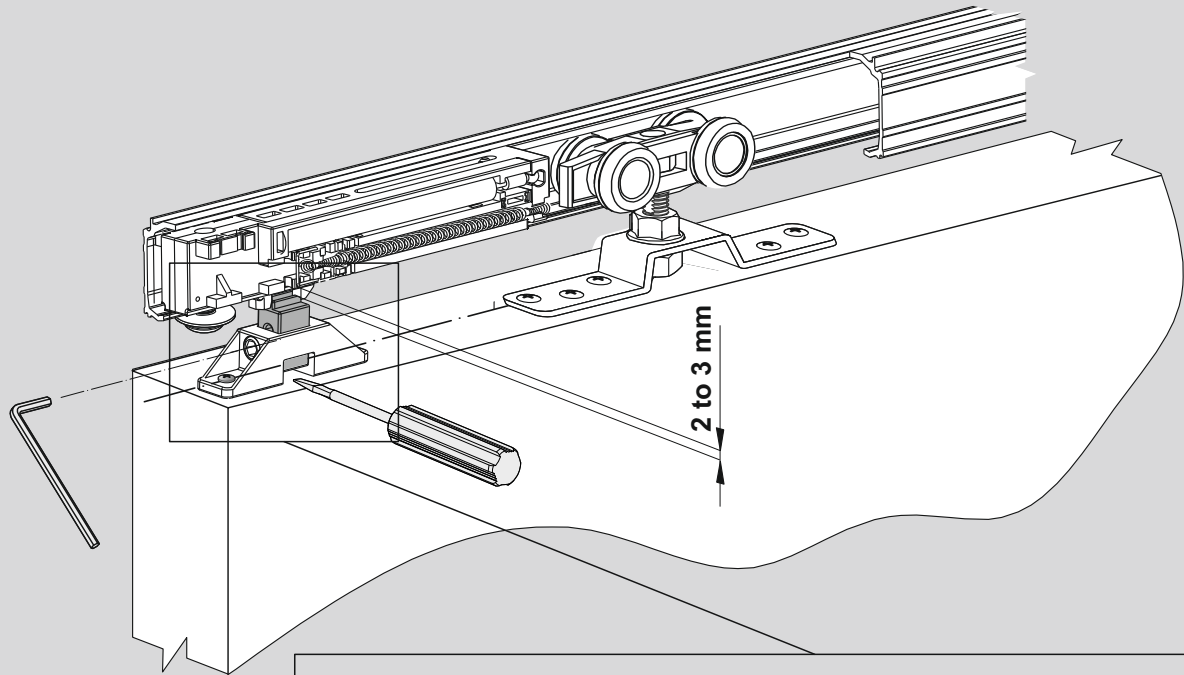
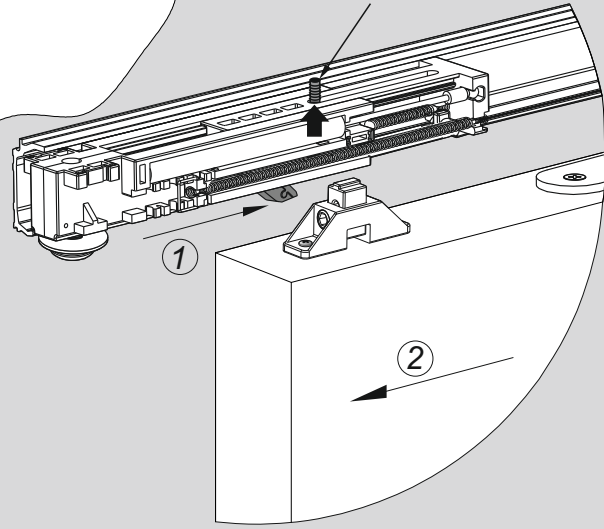

ATTENTION!
Adjust the height
of Herakles Activator
after installing the door

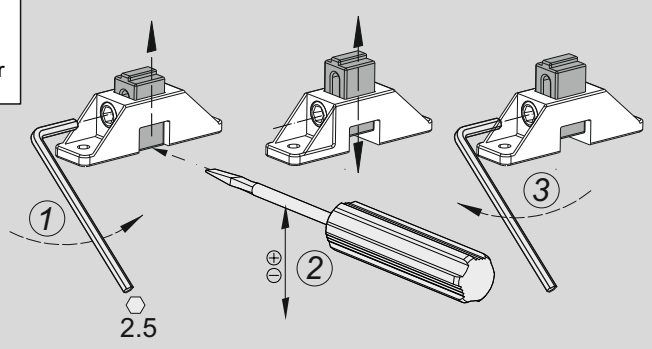



SOFT-CLOSE FOR SLIDING DOORS (TOP HUNG)

HERAKLES 40 kg or 80 kg

SEVROLL®

Montaż samodomykacza Herakles 40 kg lub 80 kg w systemie Herakles Glass

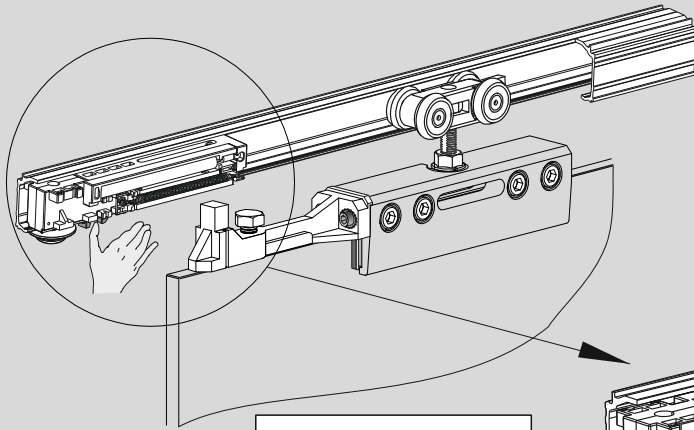

ATTENTION!
The soft-close catch
should be loaded
before inserting the door

UWAGA!
Naciągnięcie wychwyty samodomykacza
możliwe jest dopiero po wkręceniu
wkrętu dociskowego w tor

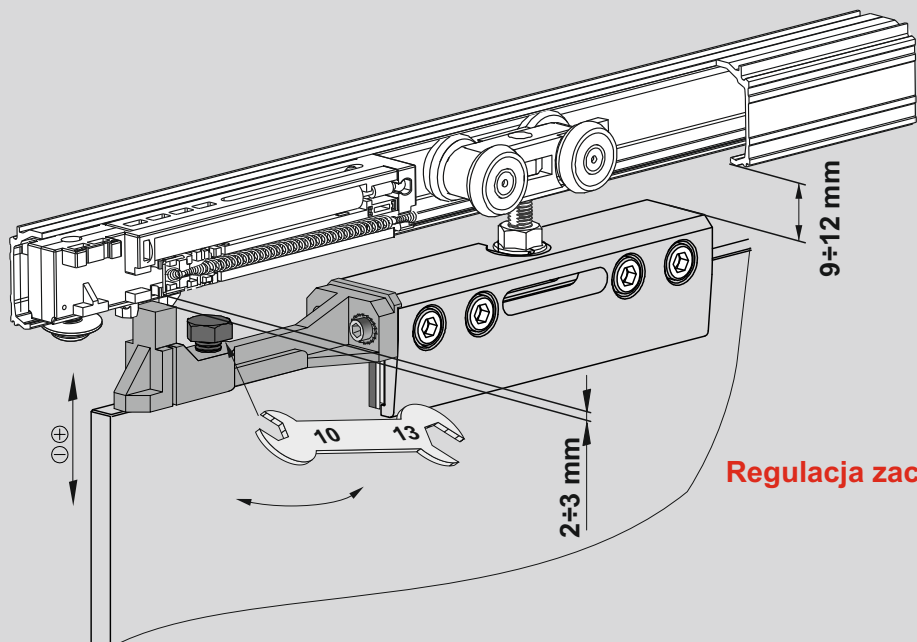
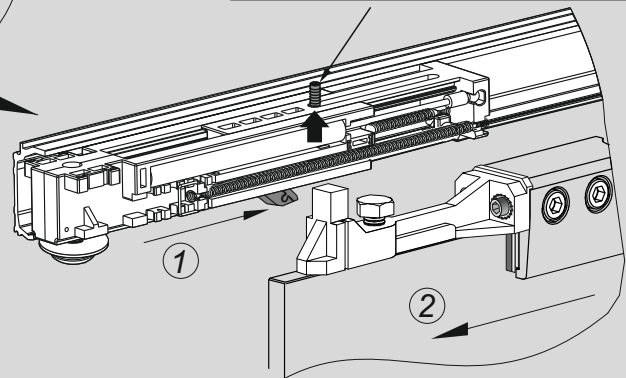

Regulacja zaczepu