

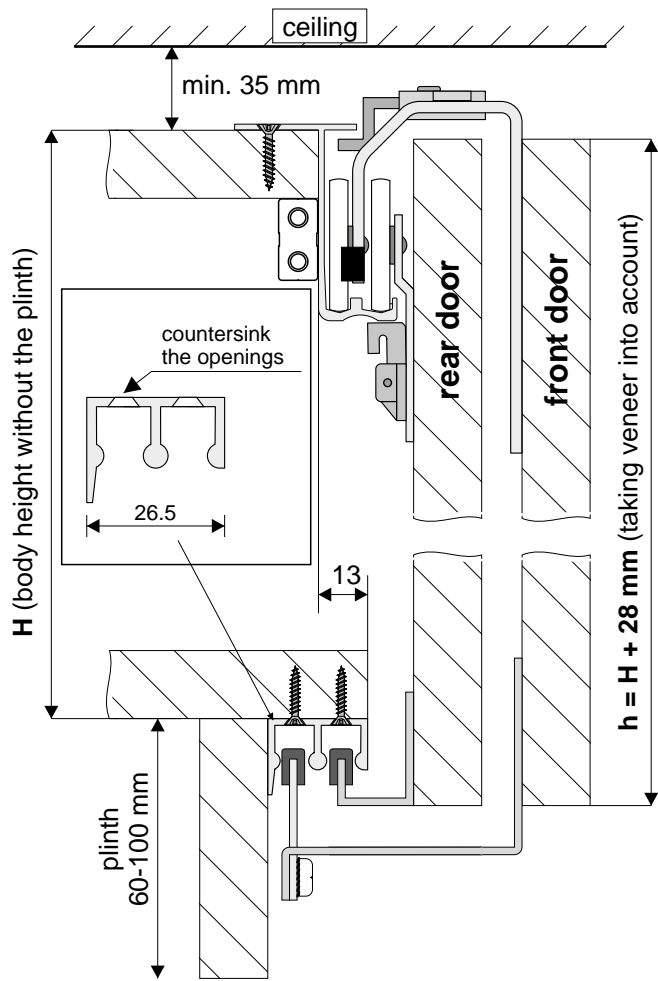

SYSTEM

# OPTIMA 18



**ATTENTION**

Door height should be greater than body height (without the plinth) by exactly 28 mm.  
 Top flange should be moved back by 13 mm in relation to the bottom flange and should be fastened firmly.  
 Thickness of board: max. 20 mm.

### Rear door assembly

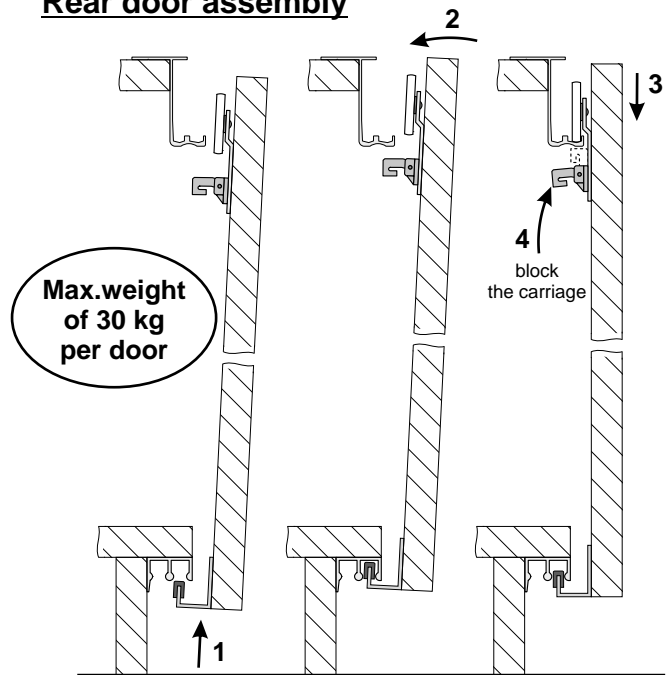

### Front door assembly

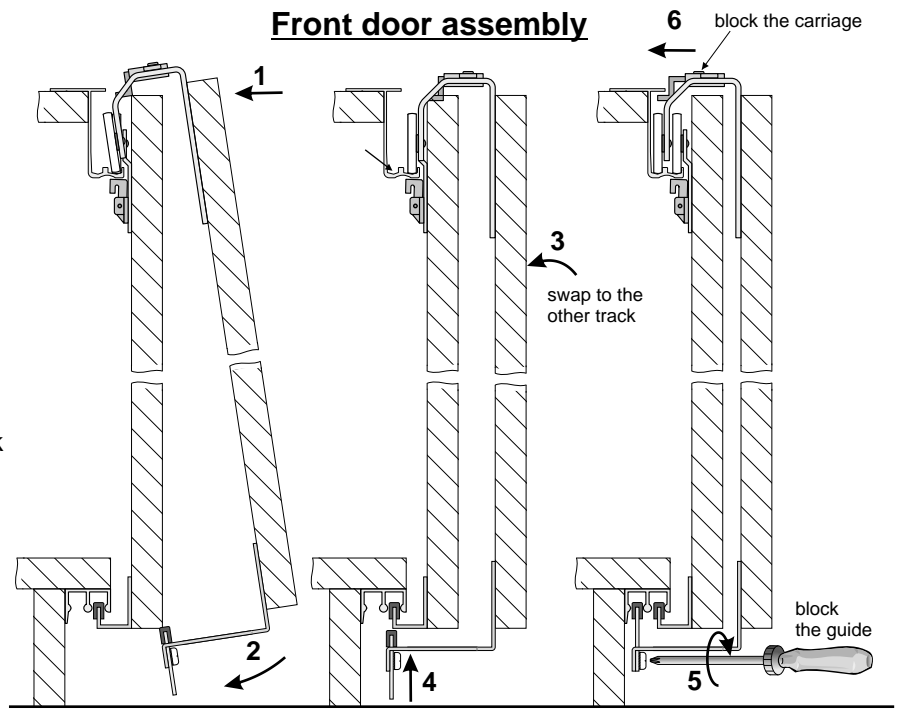
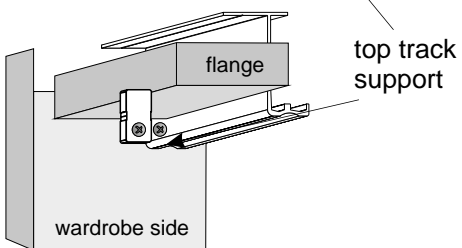
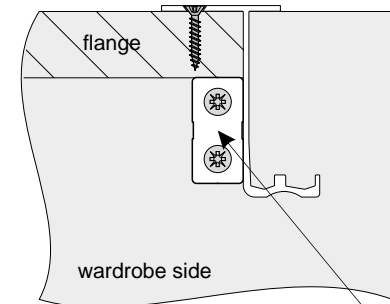

## COMPONENTS

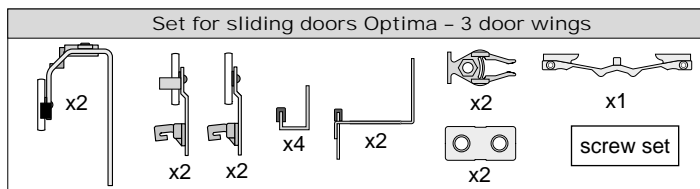
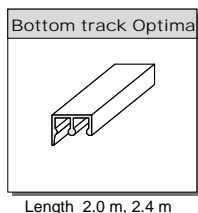
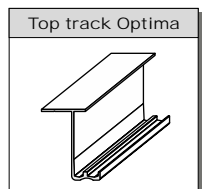

## OPTION

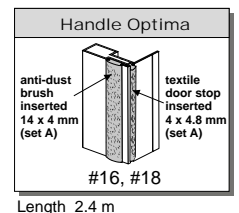



**board width calculation**

**door without vertical proles (taking edging into account)**

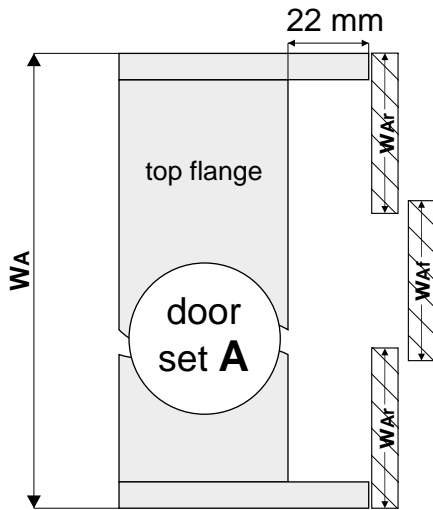

$$W_{Af} = W_{Ar} = (W_A + 40 \text{ mm}) : 3$$

**door with vertical proles (handles)**

rear door - 1 handle  
front door - 2 handles

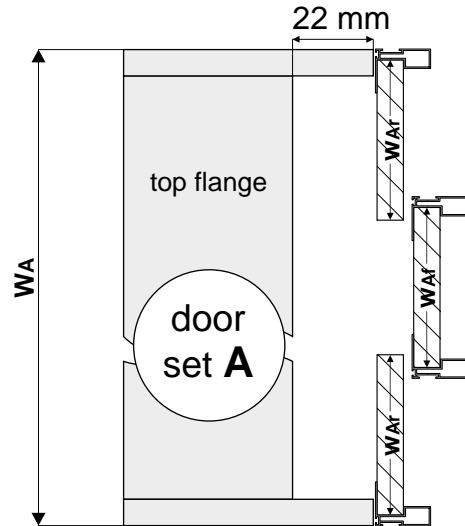

$$W_{Af} = [(W_A + 40 \text{ mm}) : 3] - 14$$

$$W_{Ar} = [(W_A + 40 \text{ mm}) : 3] - 7$$

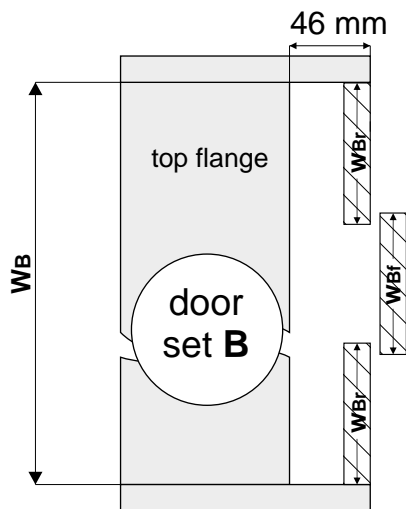

$$W_{Bf} = W_{Br} = (W_B + 40 \text{ mm}) : 3$$

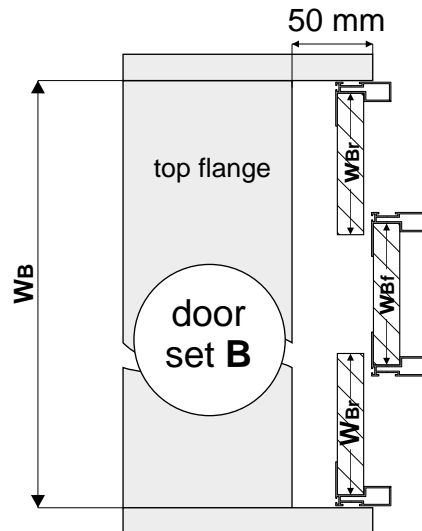

$$W_{Bf} = [(W_B + 40 \text{ mm}) : 3] - 14$$

$$W_{Br} = [(W_B + 40 \text{ mm}) : 3] - 7$$

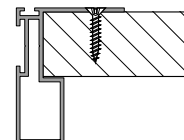

handle to be fastened with a minimum of 4 screws



## Fastening of carriages and guides to the rear door

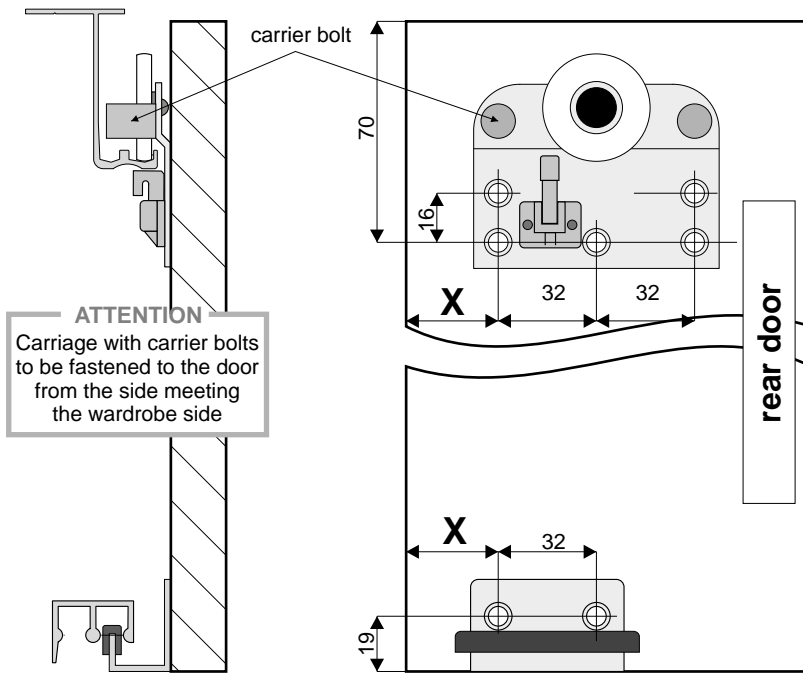

## Fastening of stopper to the top track

**rear door (set A and B)**  
door without and with vertical proles (handles)

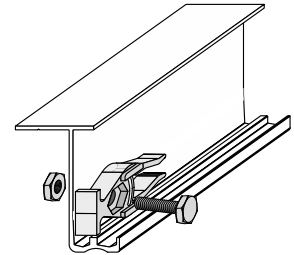

drill opening in track  $\varnothing 6$

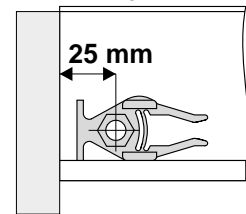

## Fastening of carriages and guides to the front door

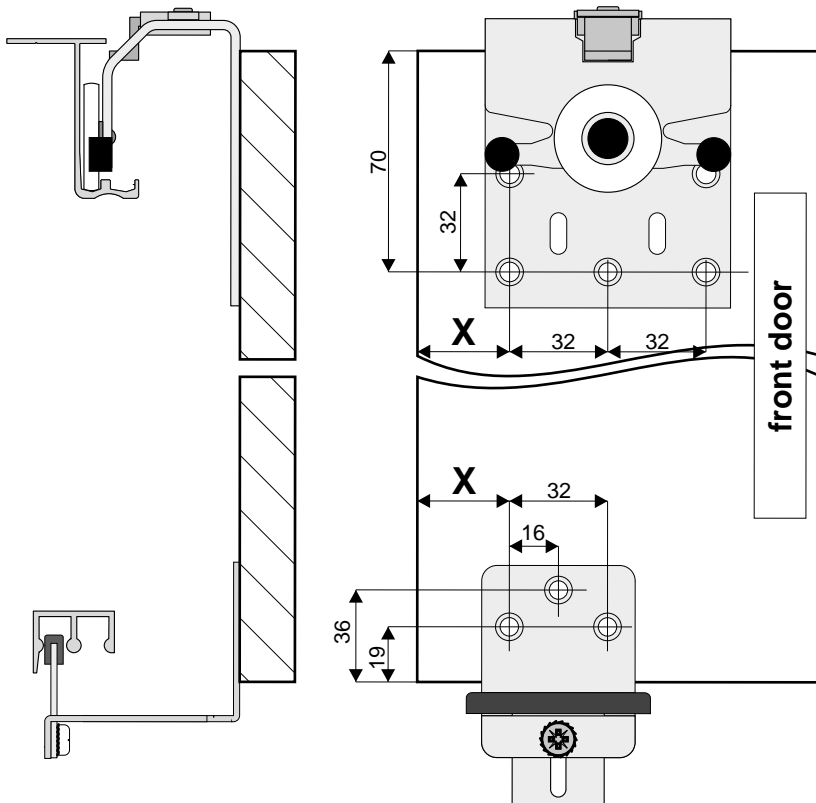

**front door**  
(fasten after door assembly)

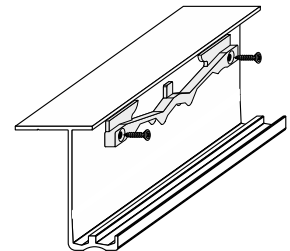

use self-tapping screw  $\varnothing 3.5$   
or drill opening in track  $\varnothing 2.5$   
and use Unix screw  $\varnothing 3.5$

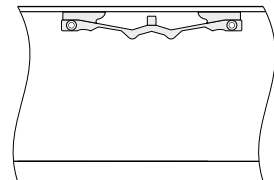

distance	door without vertical profiles		door with vertical profiles (handles)	
	door set A	door set B	door set A	door set B
<b>X</b>	58 mm	40 mm	51 mm	31 mm



Optionally, instead of stoppers, soft-closes **Optima** can be used purchased separately (only for rear door)



**Option with mirror (only available for front door wing)  
door set A and B**

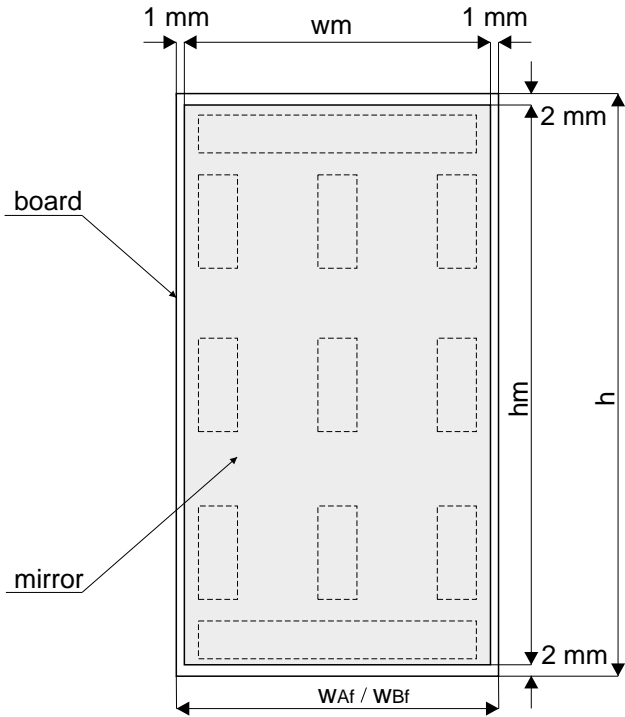

Broken line indicates recommended positioning of double-sided tape

**ATTENTION:**  
Board to mirror contact area should be free from dirt and grease before applying double-sided tape

mirror dimensions

**wm** =  $W_{Af} / W_{Bf} - 2 \text{ mm}$

**hm** =  $h - 4 \text{ mm}$

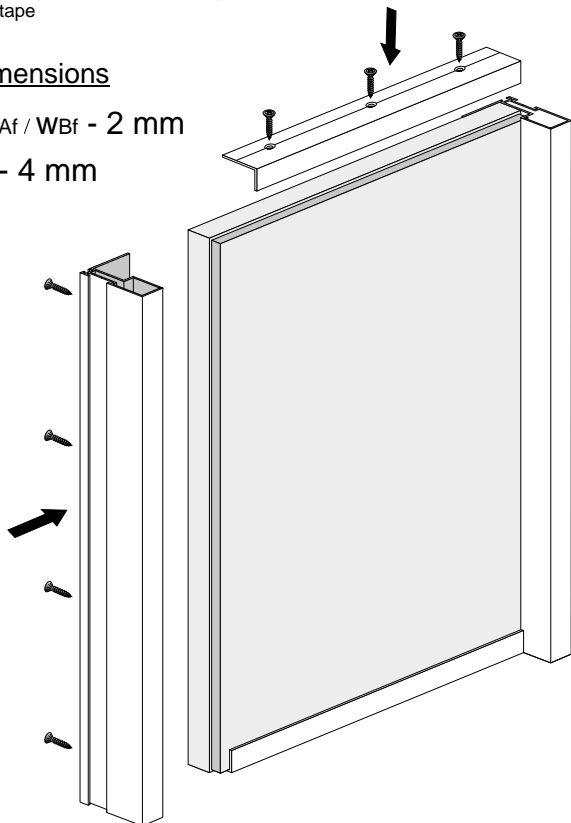

**ATTENTION!**

The usage of angle section requires the handle to be 3 mm longer than board size (protruding by: 1.5 mm - top, 1.5 mm - bottom)

Use angle section Mini

**Fitting of handle  
OPTIMA # 16**

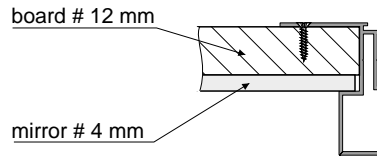

**Angle section MINI assembly**

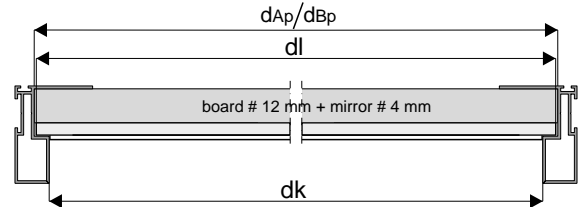
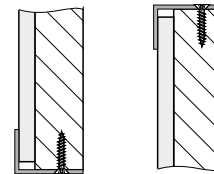

la - angle section Mini length

**la** =  $W_{Af} - 12 \text{ mm}$



for aesthetic reasons, the angle section length should be decided after handle fitting

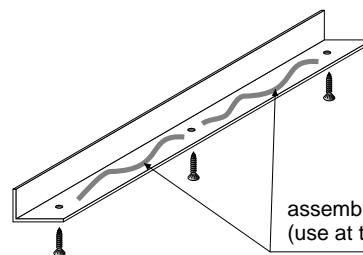

assembly adhesive (use at the bottom of the door)

**ATTENTION!**

Angle section must be fastened to board with a minimum of 3 screws  $\sim 3 \times 25$ .